



## Sensor de proximidade magnético 120

### Especificação Técnica

- Sensor magnético
- Rosca externa para rápida instalação
- Carcaça em poliamida (PA)
- Rosca M18 x 55 mm
- Cabo em PVC

### Desenho técnico

IMAGE 1/1

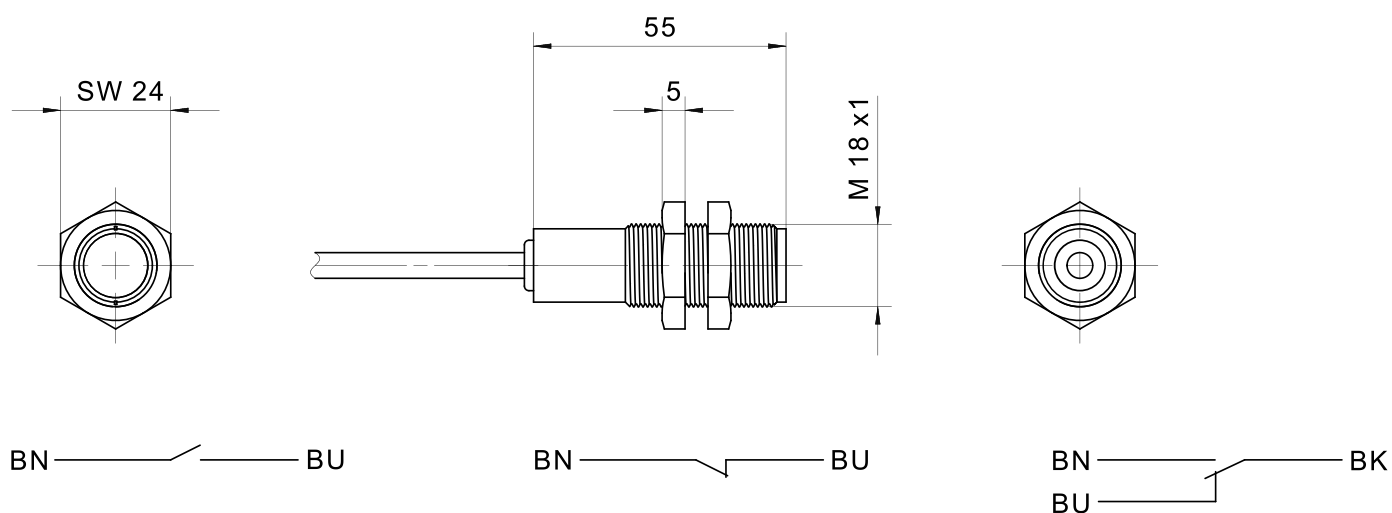

## Product options

IMAGE 1/2



## TYPICAL SWITCHING DISTANCES

	120210			120220			120230		
ACTUATORS	L1	L2	L3	L1	L2	L3	L1	L2	L3
324790	10 mm	10 mm	5 mm	6 mm	5 mm	-	12 mm	9 mm	-
300790	14 mm	13 mm	8 mm	11 mm	9 mm	-	15 mm	12 mm	7 mm
300780	22 mm	18 mm	15 mm	16 mm	14 mm	10 mm	24 mm	14 mm	12 mm

Further actuators and switching distances on request

IMAGE 2/2

## ORDERING KEY

120			Magnetic sensor, reed contact
	210		N.O. – cable connection 1 m
	220		N.C. – cable connection 1 m
	230		C.O. – cable connection 1 m
			Other electrical data on request
			Other available cable lengths
		-3	3 m
		-5	5 m
		-10	10 m
			Other cable materials and cable lengths on request

## Características do artigo

Attribute	120230	120210	120220
Max. switching voltage	48 V DC		
Max. switching voltage	48 V AC		
Max. switching current	0.3 A	1 A	
Max. switching power	3 W	20 W	
Technology	Reed		
Contact form	CO	NO	NC
LED display	No		
Actuation	arbitrary		
Switching principle	magnetic		
Dimensions	M18x1 L=55		
Housing design	cylindrical		
Housing material	PBT GF30	PA6	PBT GF30
Nut material	PBT		PA6
Cable material	PVC		
Protection class	IP67 DIN EN 60529		
Operating temperature min.	-25 °C		
Max. operating temperature	75 °C		
Min. storage temperature	-25 °C		
Max. storage temperature	75 °C		
Min. cable temperature range, moving	-5 °C		
Max. cable temperature range, moving	70 °C		
Min. cable temperature range, fixed installation	-25 °C		
Max. cable temperature range, fixed installation	70 °C		
Mounting type	Thread		
Cable length	1 m		