



Sensor de ângulo 424Z

O sensor de ângulo axial modelo 424Z tem um design compacto. Disponível opcionalmente com sinal de saída redundante torna o sensor 424Z a solução ideal para aplicações com elevado nível de segurança, especialmente para aplicações móveis. O range de medição é de 30 ° até 120 °. Devido à tecnologia de sensores de efeito Hall, trata-se de um sensor extremamente confiável e com elevada vida útil.

Especificação Técnica

- Durabilidade e confiabilidade de medição devido à tecnologia de sensores de efeito Hall
- Classe de proteção IP67
- Temperatura de trabalho -40 °C até +85 °C
- Resolução 0.1°
- Range de medição de 30° até 120°
- Sinal de saída 0.5 V – 4.5V
- Sinal de saída redundante opcional
- Travamento mecânico do eixo do sensor (180°)

Desenho técnico

IMAGE 1/5

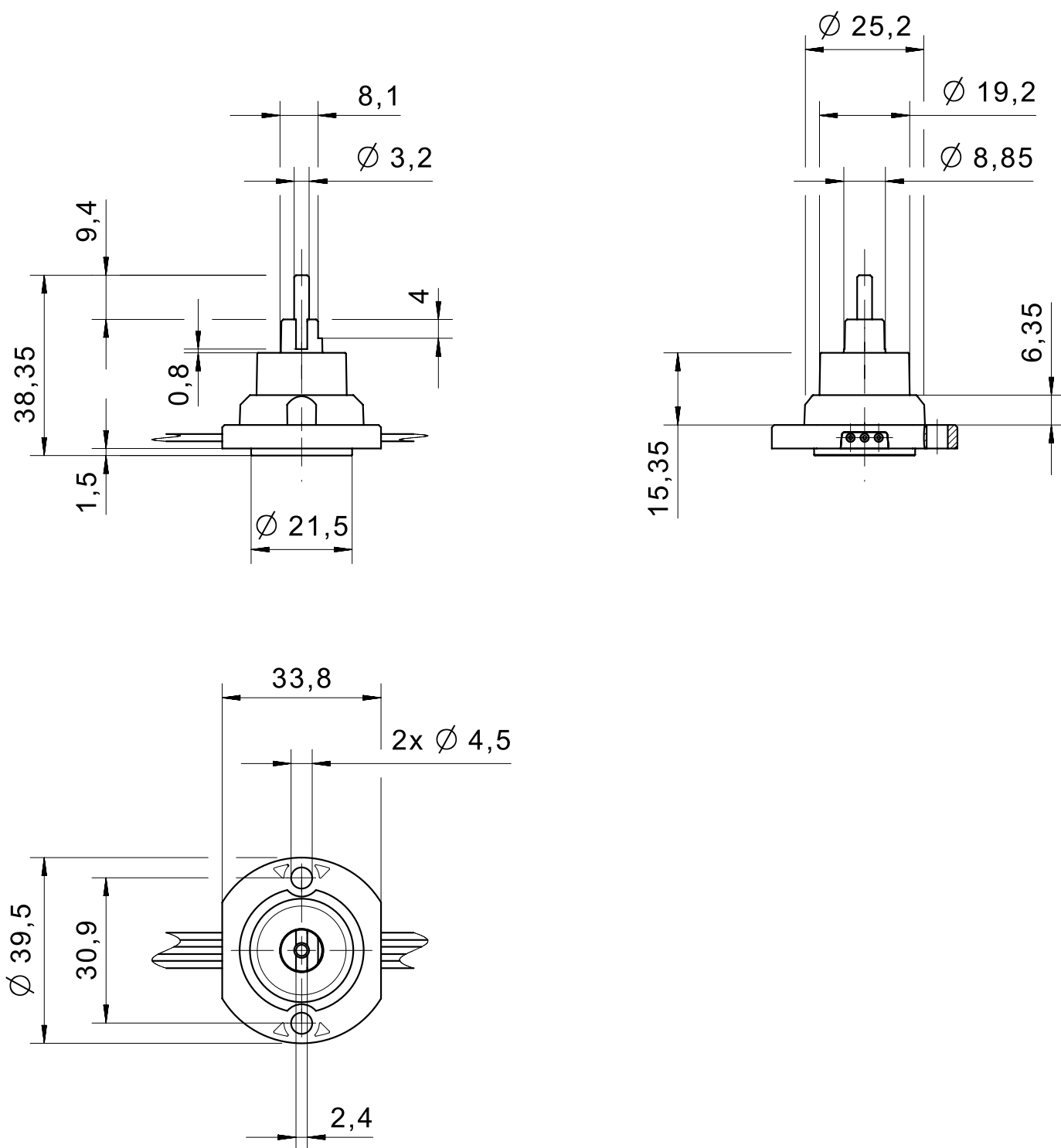
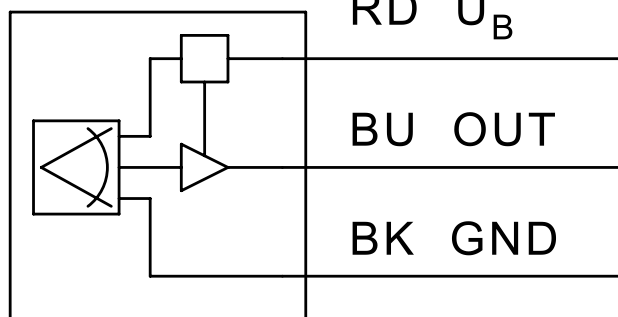

IMAGE 2/5

424ZE..



424ZP..

424ZG..

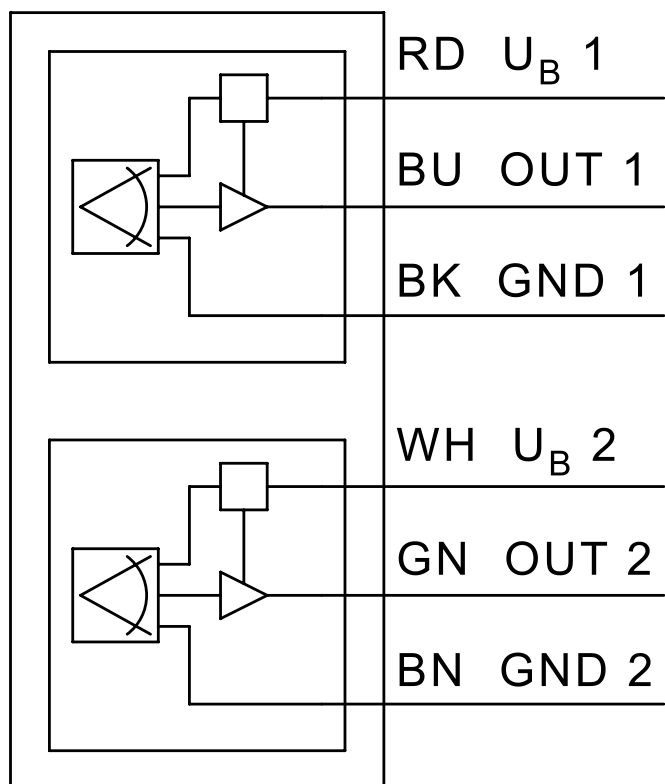
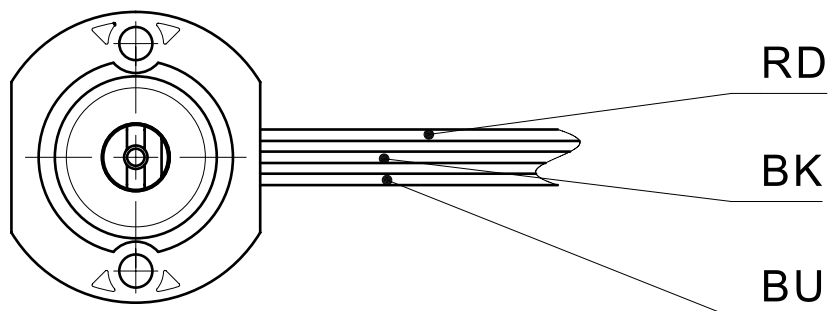

IMAGE 3/5

424ZE..



424ZP..
424ZG..

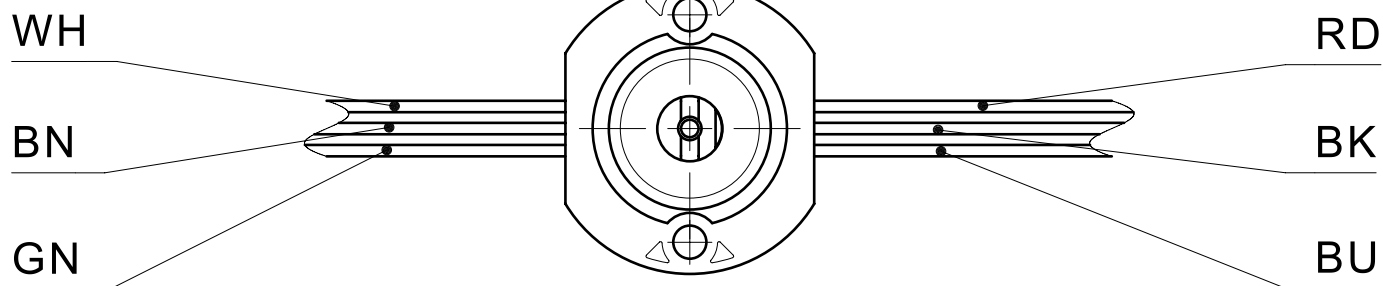
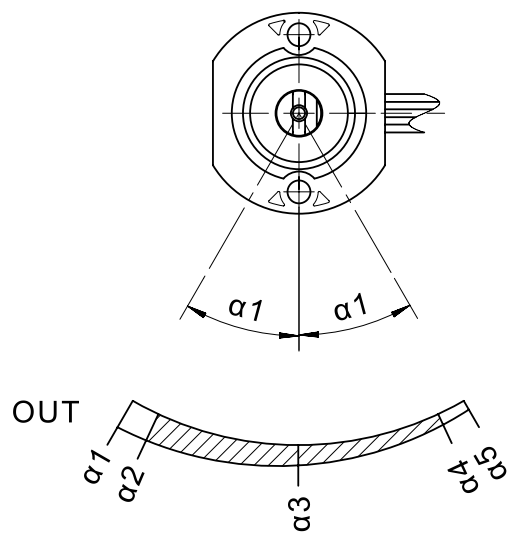

IMAGE 4/5

424ZE...CW



424ZE...CCW

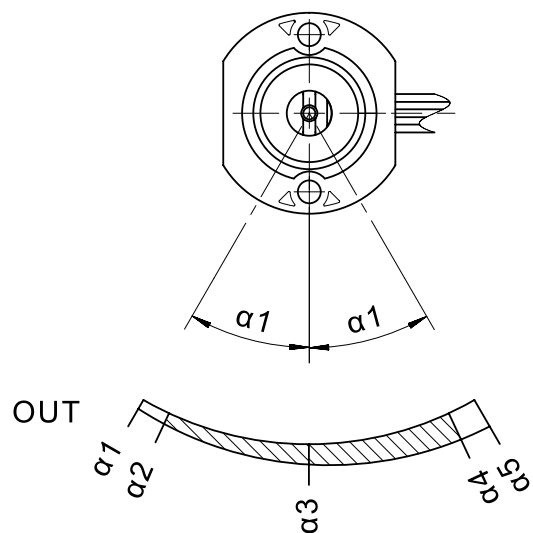
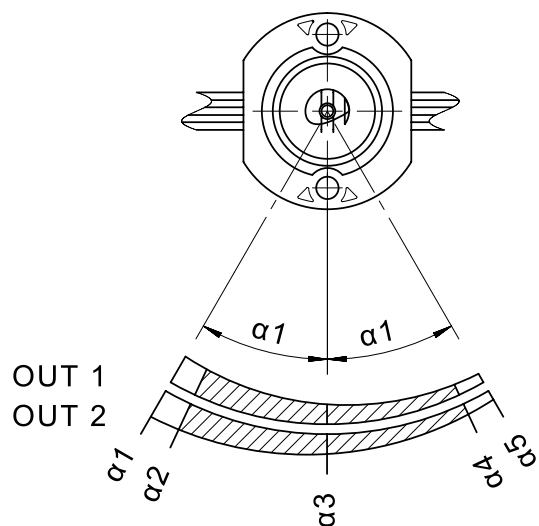
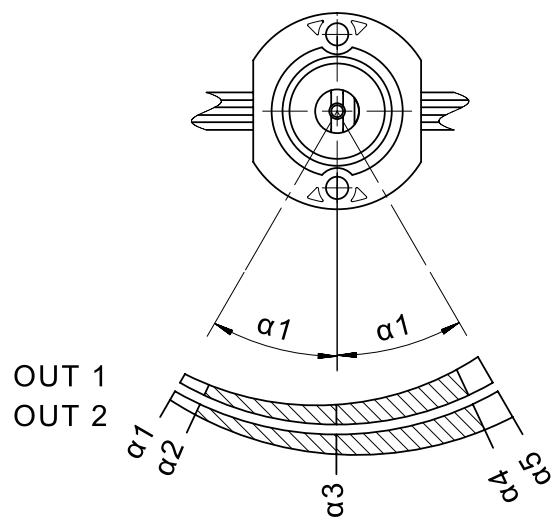

IMAGE 5/5

424ZP...CW/CW



424ZP...CCW/CCW



424ZG...CW/CCW

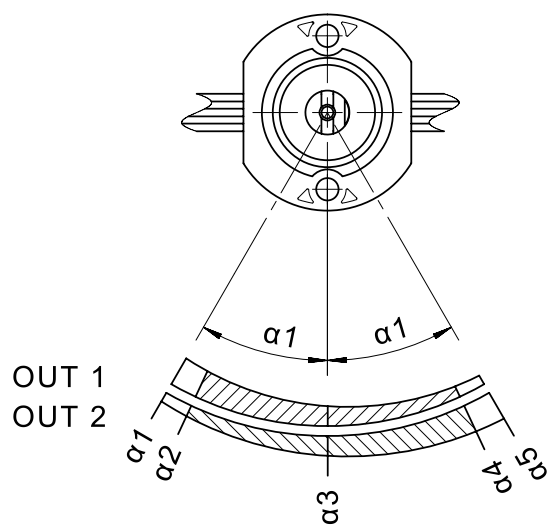

424ZG...CCW/CW

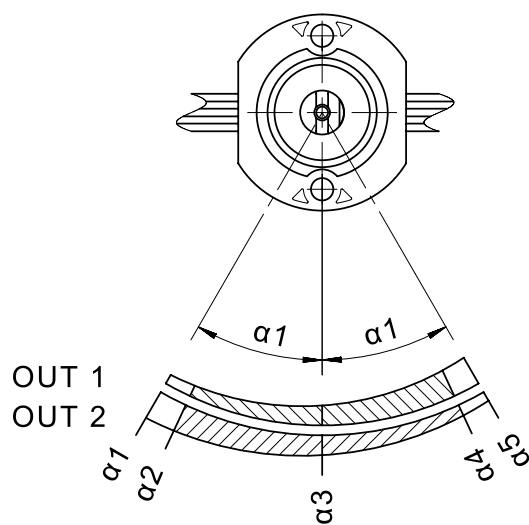

Product options

IMAGE 1/1

ORDERING KEY

424Z			Axial angle sensor 120° , magnetic + redundant
			Output signal / signal sequence
	E		Output 1 / CCW
	G		Opposite (output 1 + output 2) / CCW/CW
			Angle measuring range
		030	30°
		045	45°
		060	60°
		090	90°
		120	120°

Optional

Output signal
Parallel

Características do artigo

Attribute	424Z...	ED424Z...
Polarity reversal protection	yes	-
Output signal min.	0.5 V DC	-
Output signal max.	4.5 V DC	-
Output signal - centre position/zero position	2.5 V DC	-
Resolution	0.1 °	-
Operating voltage min.	4.5 V DC	-
Operating voltage max.	5.5 V DC	-
Current consumption	10 mA	-
Temperature coefficient	typ. +- 250 ppm/K	-
Signal sequence	CCW or CCW/CW	-
Signal update rate	2000 Hz	-
Outputs (quantity, type)	1 or 2	-
Technology	Hall	-
Angle measuring range	30° ... 120 °	-
Outputs	0,5...4,5V	-
MTTF	717.9 a	-
Load resistance min.	10000 Ohm	-
Typical linearity error	= +/-15° : +/-0,2° = +/-25° : +/-0,4° = +/-35° : +/-1,0° = +/-45° : +/-2,0° = +/-60° : +/-5,0°	-
EMC Agricultural and forestry machines (Norm)	EN ISO 14982 conducted disturbance not applicable for 5V supply	-
EMC Earth-moving and building construction machinery (Norm)	DIN EN ISO 13766-1 conducted disturbance not applicable for 5V supply	-
EMC Industrial trucks (Norm)	DIN EN 12895	-
Max. shaft load, axial	0 N	-
Max. shaft load, radial	0 N	-
Bearing	Plastic plain bearing	-
Mechanical stop	yes	-
Protection class	IP67 DIN EN 60529	-
Operating temperature min.	-40 °C	-
Max. operating temperature	85 °C	-

Attribute	424Z...	ED424Z...
Min. storage temperature	-40 °C	-
Max. storage temperature	85 °C	-
Min. cable temperature range, fixed installation	-40 °C	-
Max. cable temperature range, fixed installation	105 °C	-
Torque for fastening screws	1 N m	-
Cable type	Strand	-
Cable length	0.5 m	-