



Sensor de segurança magnético 122MSV

O sensor de segurança magnético modelo 122MSV é o sensor mais compacto disponível no mercado. A carcaça em aço inoxidável totalmente vedada pode suportar jatos d'água, produtos químicos e temperaturas extremas de -25 ° C até +80 ° C, com classe de proteção IP6K9K.

O sensor de segurança magnético modelo 122MSV permite uma distância de comutação de até 9,5 mm. É a solução ideal para aplicação na indústria de alimentos e embalagens.

Especificação Técnica

- Flexibilidade de instalação
- Classe de proteção IP6K9K, ideal para aplicações que exigem resistência à jatos d'água
- Conector M12
- Atuador magnético em carcaça M12 (código: 122MBV100)

Desenho técnico

IMAGE 1/3

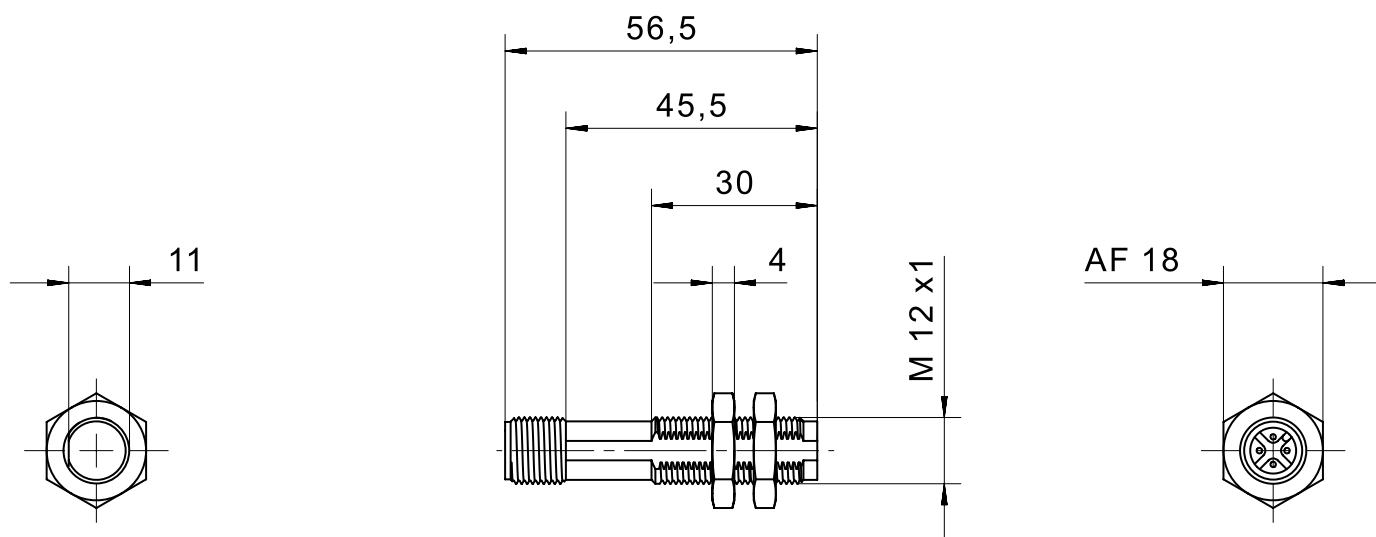

IMAGE 2/3

male M12

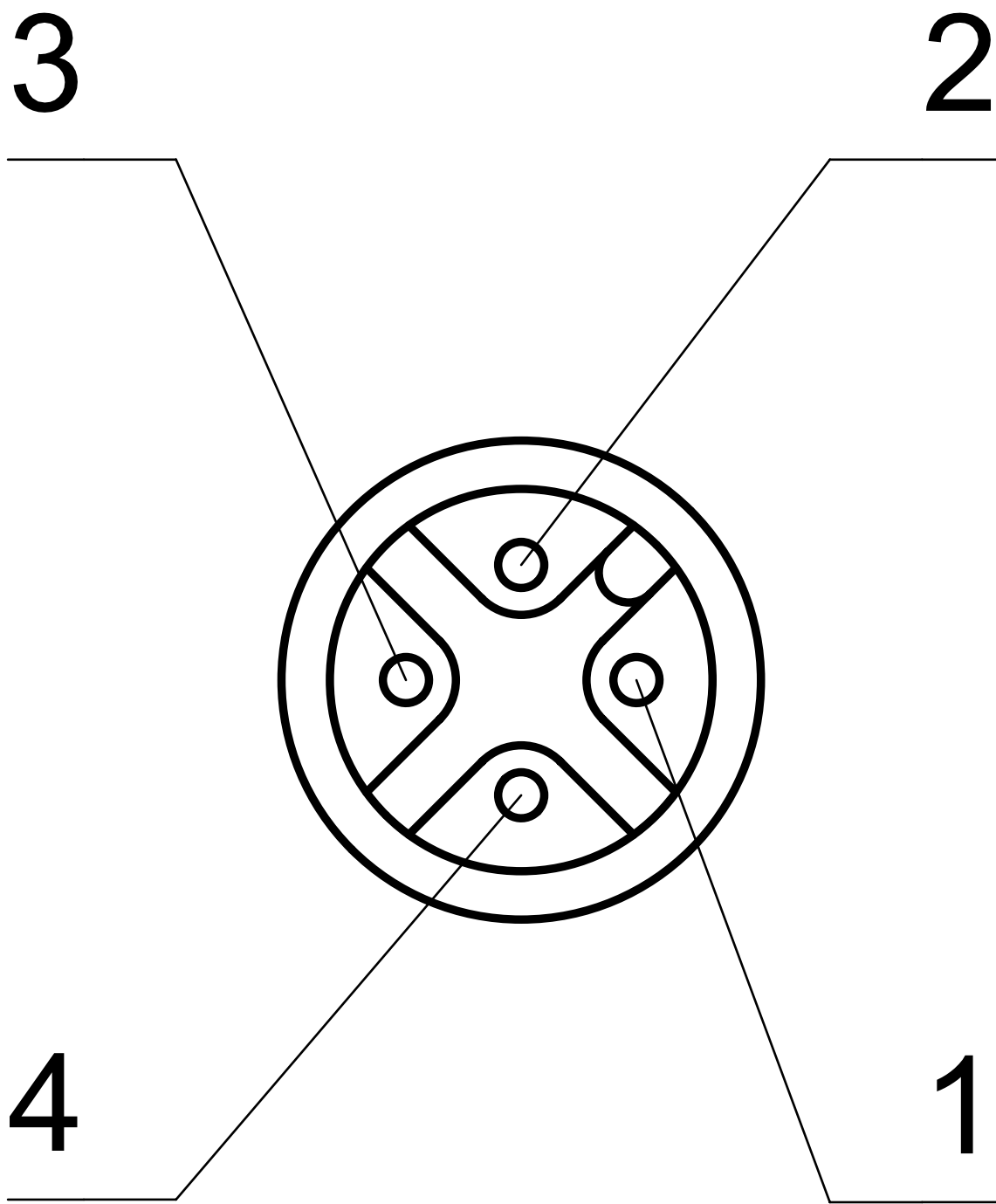
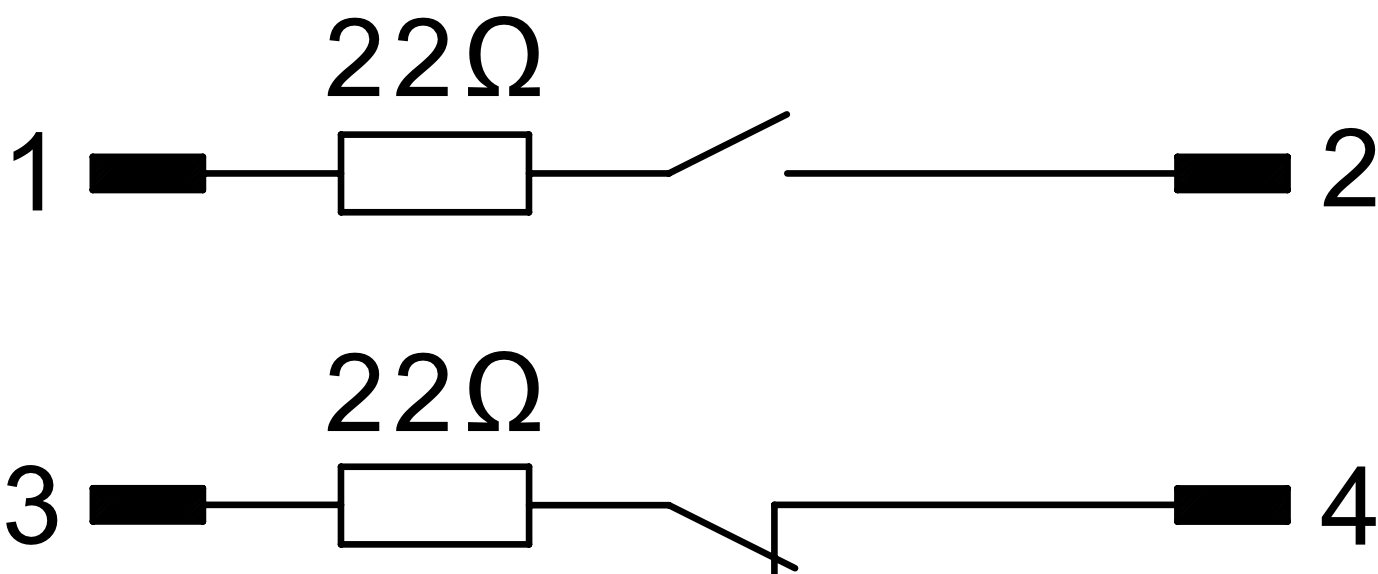

IMAGE 3/3

122MSV10G1G



Product options

IMAGE 1/2

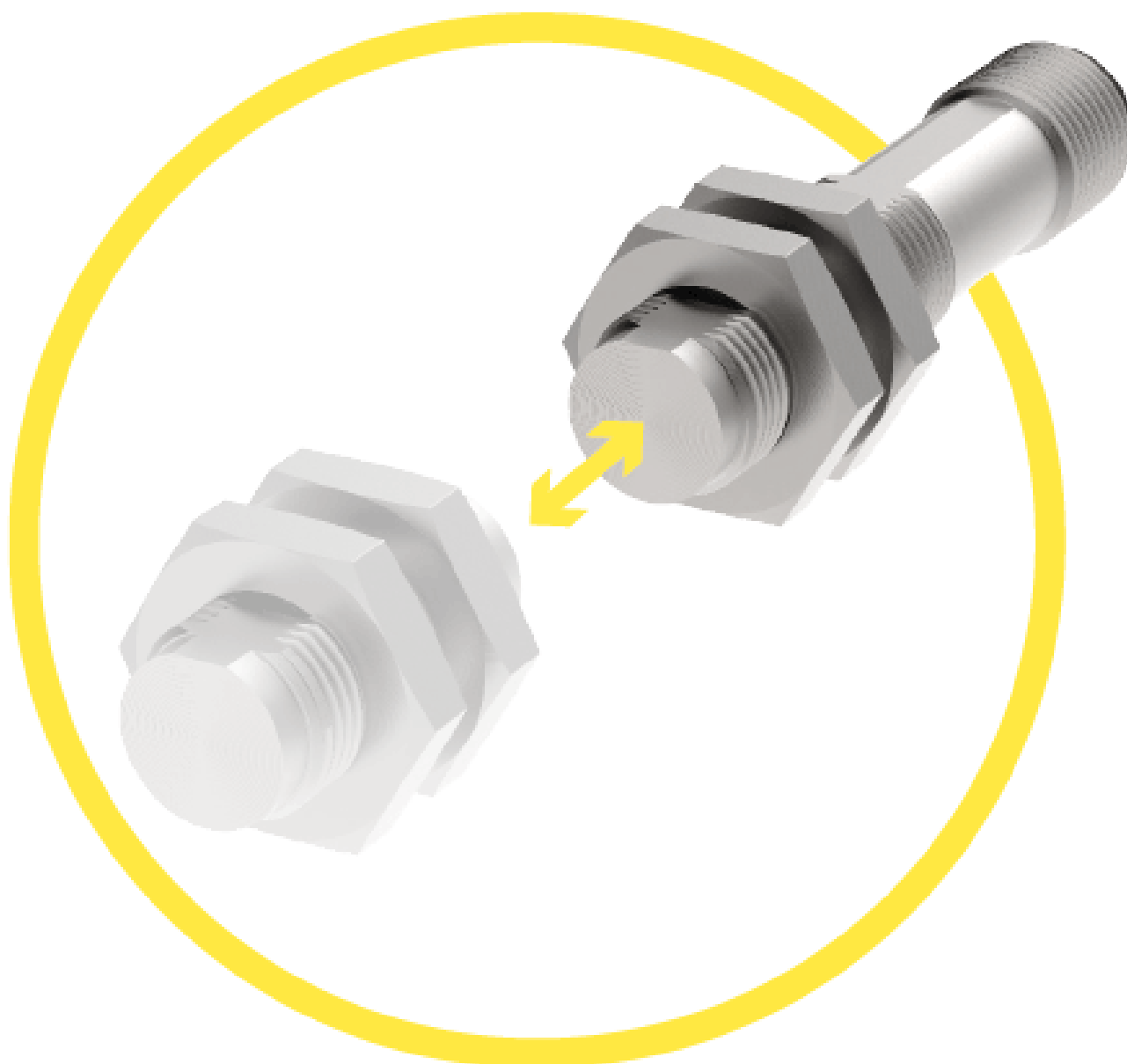

**Suitable for front actuation. Offset with magnet systems
122 MBV 100: max. 5 mm. Operating distance (Sao) from
5 to 9.5 mm. Assured switch-off distance (Sar) 25 mm**

IMAGE 2/2

ORDERING KEY

	122MSV10G1G
Stainless steel housing M12	x
M12x1 plug connection, 4-pin	x
N.O./N.C. contacts	x
Coded	x
Uncoded	-

MATCHING ACTUATORS

Actuators	Actuation direction	120V62V			
	Front	$S_{0_{min}}$	S_{ao}	S_{ar}	
122 MBV 100		0.5	9.5	25	

$S_{0_{min}}$ = minimum switching distance (mm), S_{ao} = operating distance (mm), S_{ar} = assured switch-off distance (mm)

Características do artigo

Attribute	122MSV10G1G	ED122MSV10G1G
Min. switching voltage	19.2 V DC	-
Max. switching voltage	28.8 V DC	-
Max. switching current	0.1 A	-
Max. switching power	3 W	-
Switching frequency	5 Hz	-
Assured switching distance (Sao)	9.5 mm	-
Assured switch-off distance (Sar)	25 mm	-
Minimum switching distance (SO min)	0.5 mm	-
LED display	No	-
Actuation	front	-
Switching principle	magnetic	-
Series resistor	22 Ohm	-
Technology	Reed	-
Contact form	NO/NC	-
Pollution degree	3	-
Protection class	III	-
Coding acc. to EN ISO 14119	Low	-
B10d acc. to EN ISO 13849-1	20000000	-
Type acc. to EN ISO 14119	4	-
Mission time in years	20 a	-
Structure acc. to EN ISO 13849-1	Two-channel	-
Housing colour	silber	-
Housing design	cylindrical	-
Dimensions	M12 x 55,5 mm	-
Detent present	no	-
cannot be mounted flush	yes	-
Housing material	Edelstahl	-
Nut material	Edelstahl	-
Protection class	IP68 DIN EN 60529	-
Protection class, connector	IP68 DIN EN 60529	-
Operating temperature min.	-25 °C	-

Attribute	122MSV10G1G	ED122MSV10G1G
Max. operating temperature	80 °C	-
Shock resistance (Norm)	30g / 11ms	-
Vibration resistance (Norm)	10 - 55Hz	-
Min. storage temperature	-25 °C	-
Max. storage temperature	80 °C	-
Mounting type	Fastening nut	-
Thread	M12	-
Connector type	M12x1 - 4 polig	-
CE label	yes	-
Possible actuators	122MBV100	-