



Conector Circular M12 4-pinos

- Elevada classe de proteção e de temperatura de trabalho para atender às demandas de ambientes industriais adversos
- Conector circular para montagens customizadas

Desenho técnico

IMAGE 1/6

351150

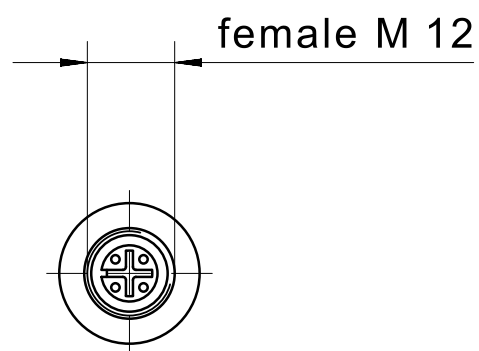
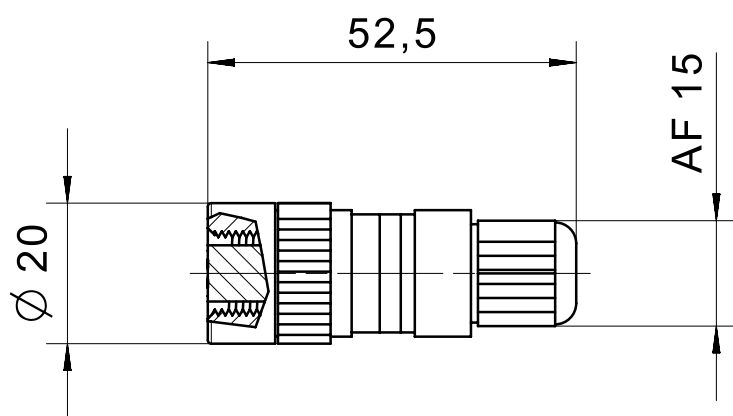
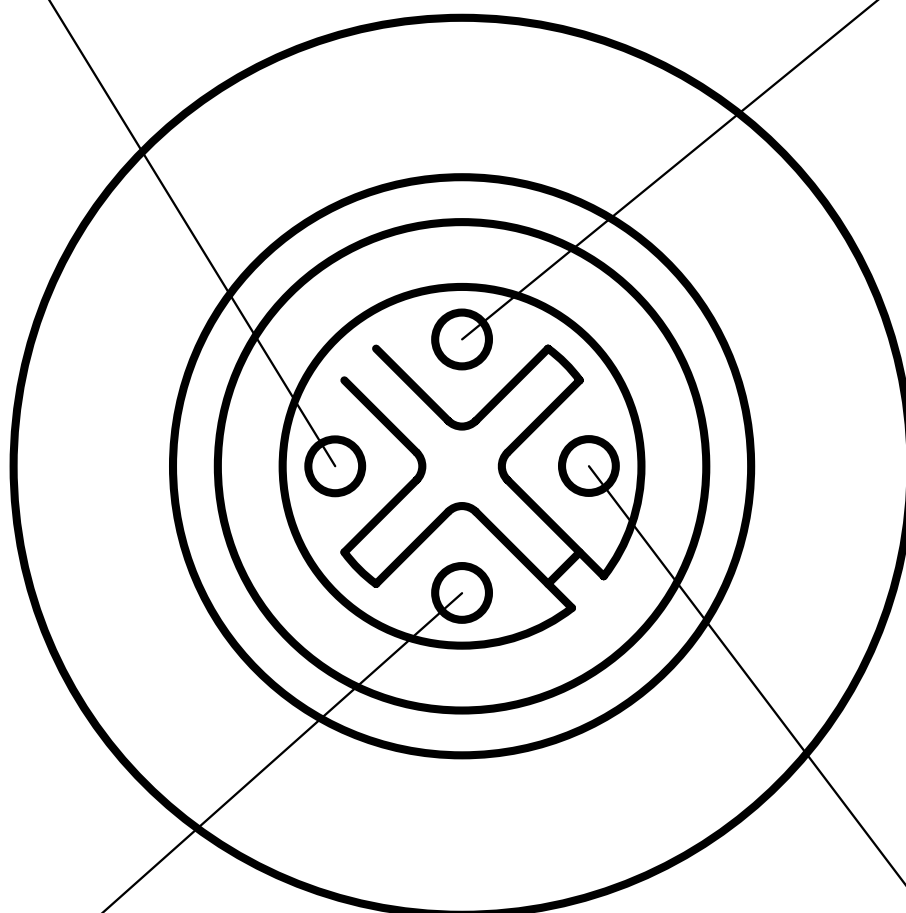

IMAGE 2/6

female M12

3

4



2

1

IMAGE 3/6



IMAGE 4/6

351151

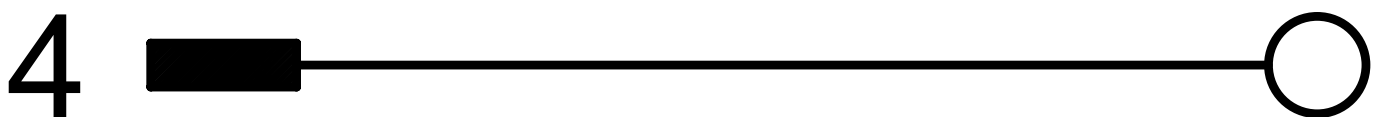

IMAGE 5/6



 Status	Maßstab		Benennung
	Revision	E	Kupplungsdose
	Gepr. Datum	29.03.19	Nummer
	Geprüft	pr1mi	Cat_351151

IMAGE 6/6



Product options

IMAGE 1/1

ORDERING KEY

351		Circular connector, 4-pin
	152	Coupling socket M8
	153	Coupling connector M8
	150	Coupling socket M12
	151	Coupling connector M12
		more coupling sockets / connectors on request

Características do artigo

Attribute	351150	351151	ED351150	ED351151
Pollution degree	3		-	
Max. switching current per contact	4 A		-	
Rated impulse withstand voltage (Uimp)	2500 V		-	
Operating voltage max.	240 V DC		-	
Operating voltage max.	240 V AC		-	
Nut material	CuZi nickel-plated		-	
Overmould material	PA		-	
Operating temperature min.	-40 °C		-	
Max. operating temperature	85 °C		-	
Min. storage temperature	-40 °C		-	
Max. storage temperature	85 °C		-	
Torque for nuts	0,5 N m		-	
Connector type	M12 socket, straight	M12 connector, straight	-	
Cable diameter	3 - 6,5 mm		-	
Number of pins	4		-	
Connection type	Screw connection		-	
Min. connection cross section	0.14 mm²		-	
Max. connection cross section	0.75 mm²		-	
Certified in accordance with	UL 2238/CSA22.2		-	