



Sensores Conector M8 4 pinos com anel de acoplamento

Especificação Técnica

- Elevada resistência a produtos químicos

Desenho técnico

IMAGE 1/6

351152

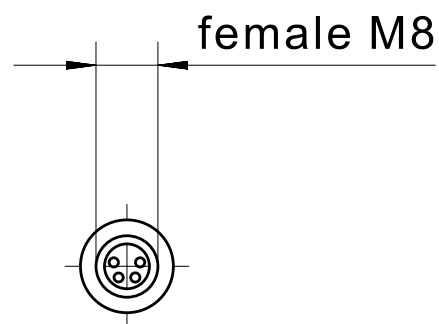
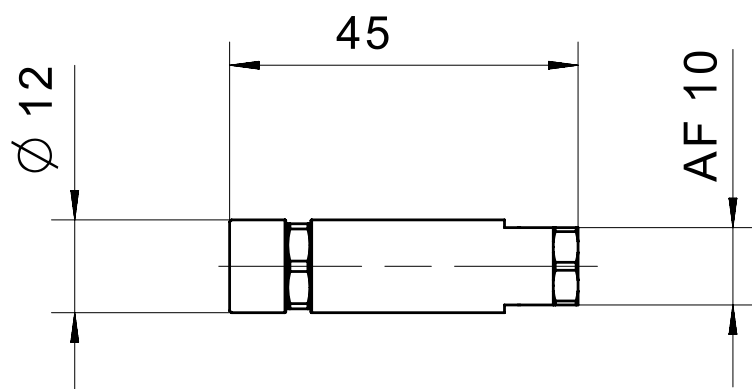

IMAGE 2/6

female M8

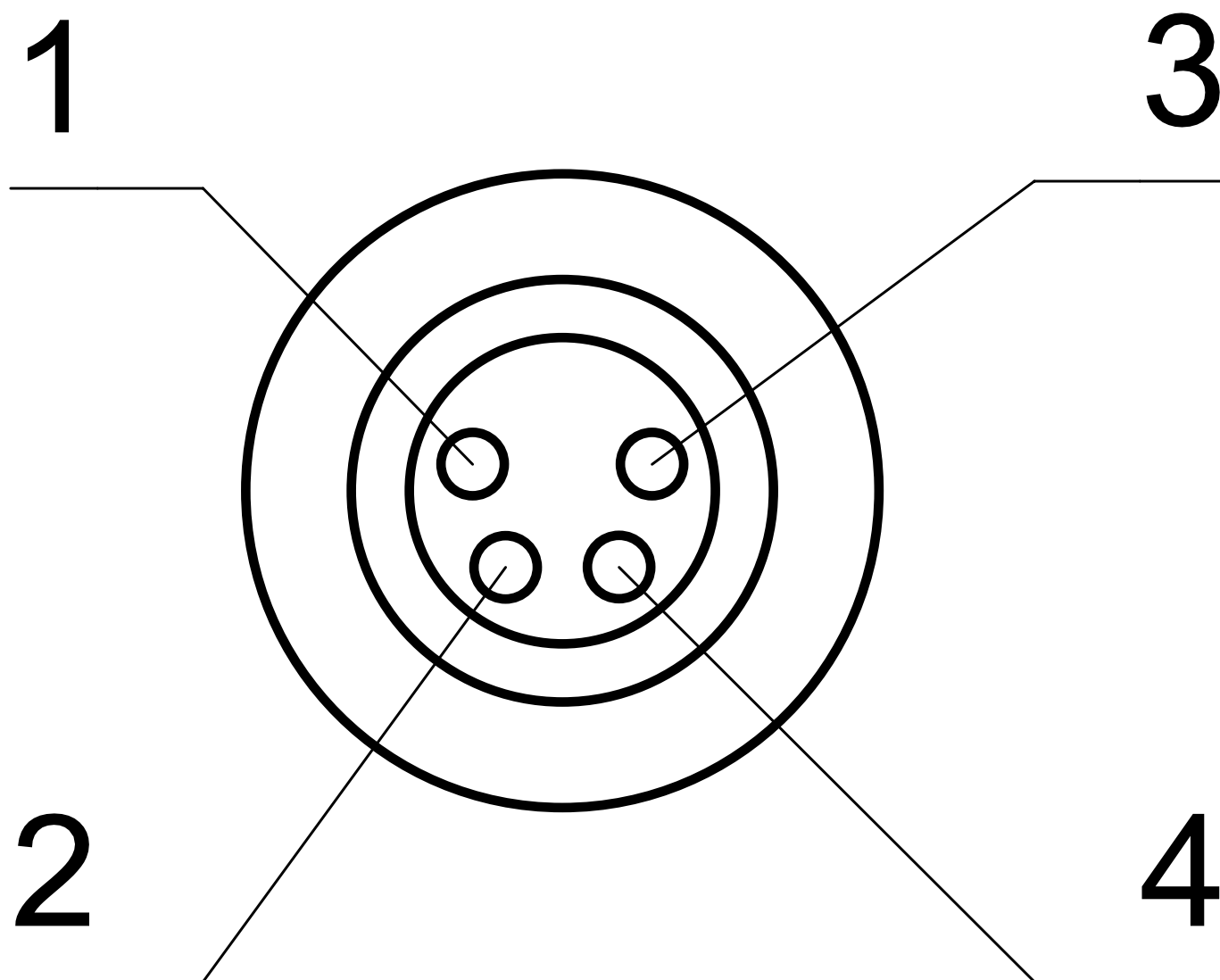

IMAGE 3/6

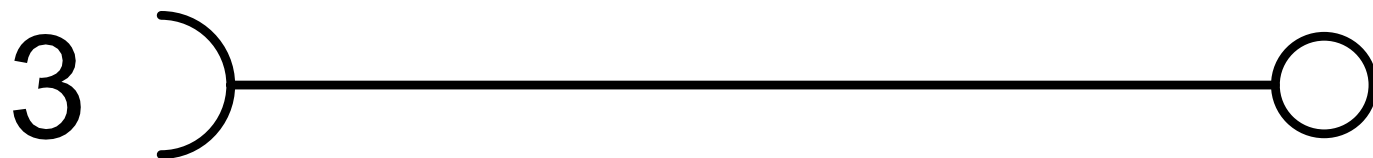

IMAGE 4/6

351153

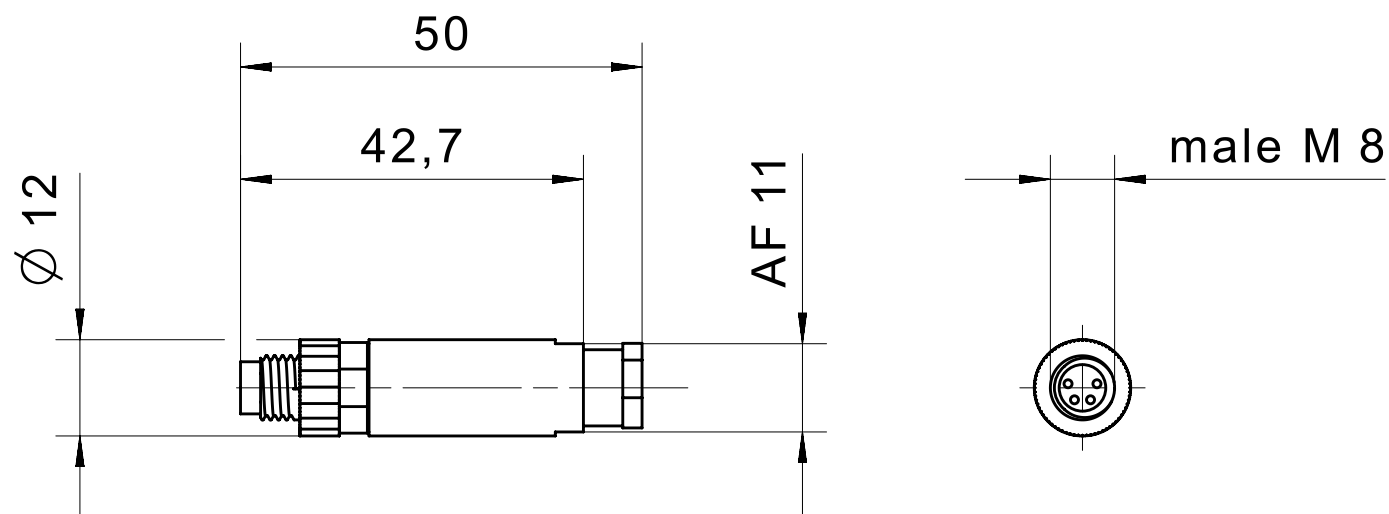

IMAGE 5/6

male M8

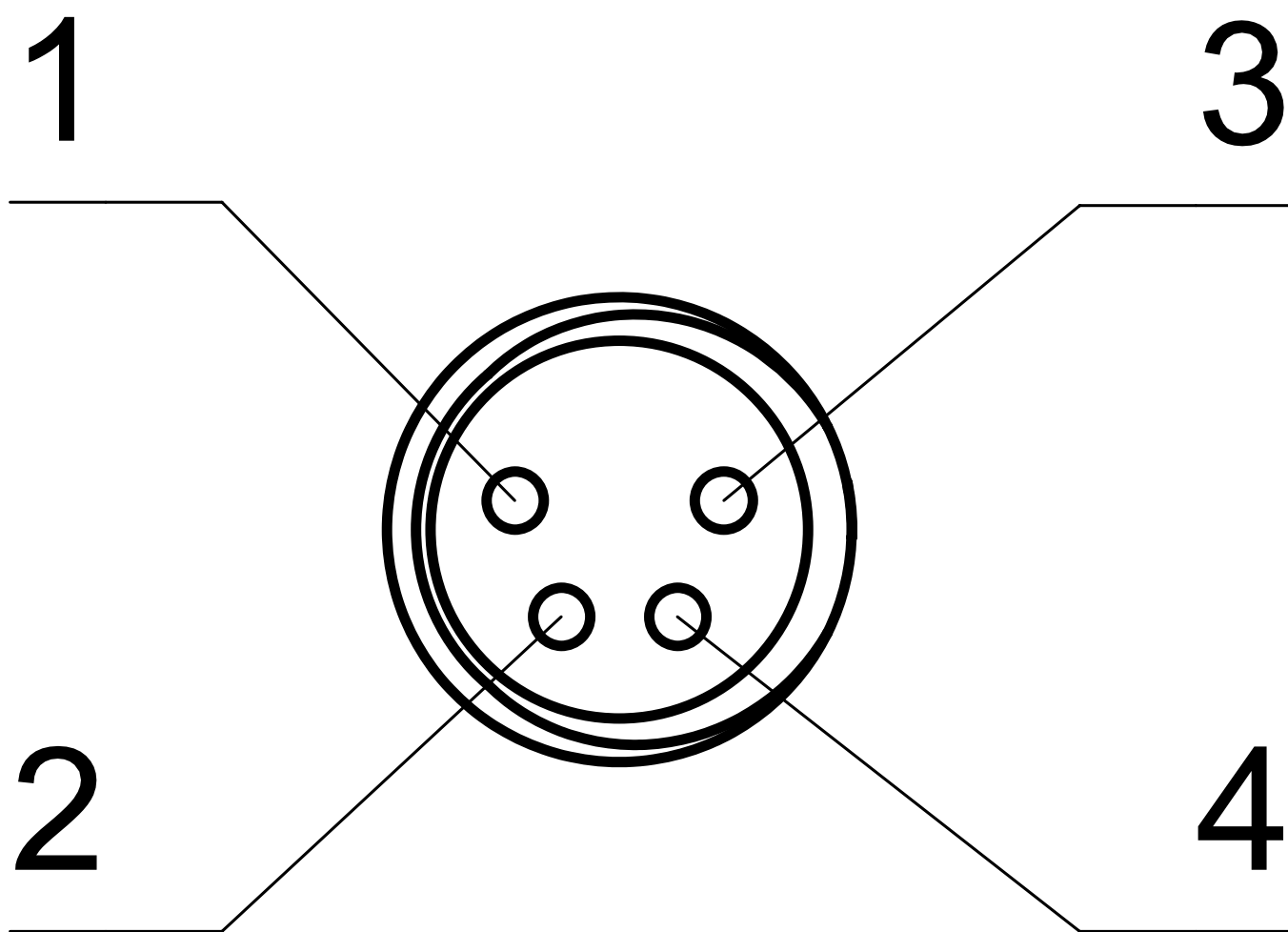
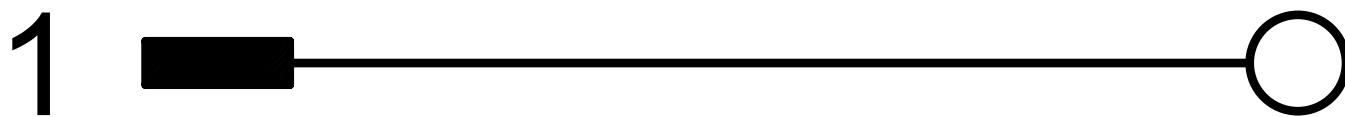

IMAGE 6/6



Product options

IMAGE 1/1

ORDERING KEY

351		Circular connector, 4-pin
	152	Coupling socket M8
	153	Coupling connector M8
	150	Coupling socket M12
	151	Coupling connector M12
		more coupling sockets / connectors on request

Características do artigo

Attribute	351152	351153	ED351152	ED351153
Max. switching current per contact	4 A			-
Rated impulse withstand voltage (Uimp)	800 V			-
Operating voltage max.	240 V DC			-
Operating voltage max.	240 V AC			-
Nut material	CuZi nickel-plated			-
Overmould material	PA			-
Operating temperature min.	-40 °C			-
Max. operating temperature	85 °C			-
Min. storage temperature	-40 °C			-
Max. storage temperature	85 °C			-
Pollution degree	3			-
Torque for nuts	0,5 N m			-
Connector type	M8 socket, straight	M8 connector, straight		-
Cable diameter	3,5 - 5,5 mm			-
Number of pins	4			-
Connection type	Screw connection			-
Min. connection cross section	0.14 mm²			-
Max. connection cross section	0.5 mm²			-