

Plunger switch 144

The plunger-operated switches from elobau are extremely robust. The robustness is ensured by the high leak tightness in accordance with IP67, together with a high level of temperature stability and vibration resistance. The robust design and availability of different versions make them extremely versatile in use. Depending on the version, they can be used to detect the positions of shafts or pistons in different applications.

Typical applications are gearboxes, drive and conveyor components or the sensing of end positions in industrial applications.

Product characteristics

- Extreme operating temperature range from -25 °C to +130 °C
- IP67 protection class
- Various materials and designs available
- Variants with cable output as well as various connectors
- Different options for switching paths (4-12mm)
- Can be modified according to requirements

Technical drawing

IMAGE 1/3

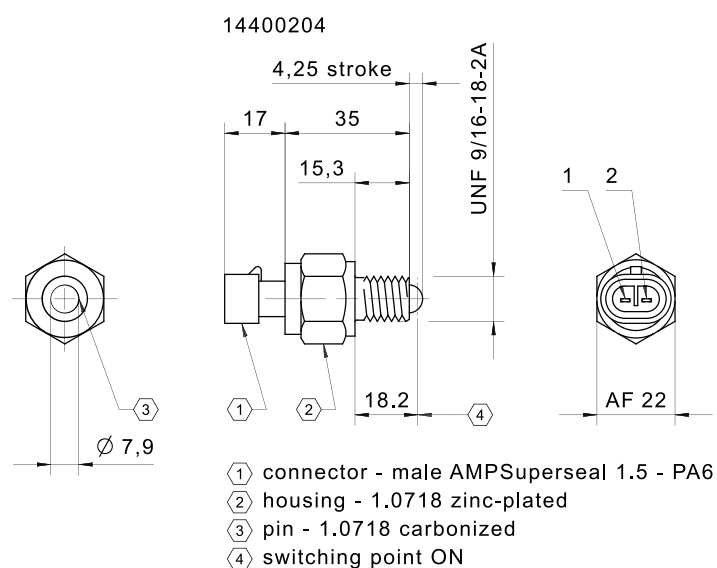
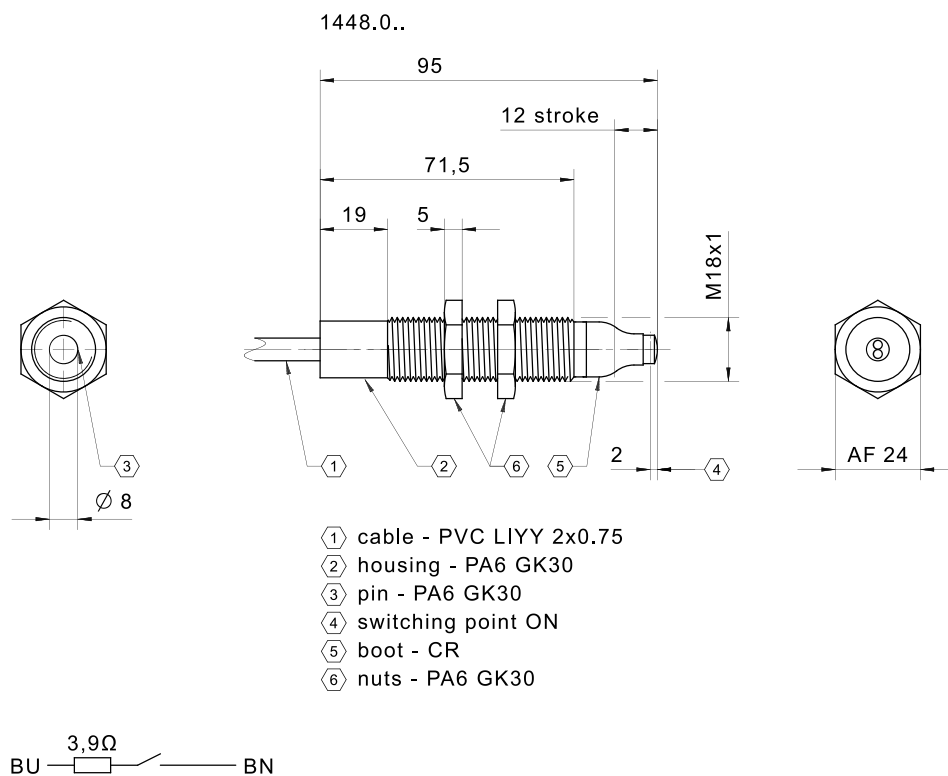
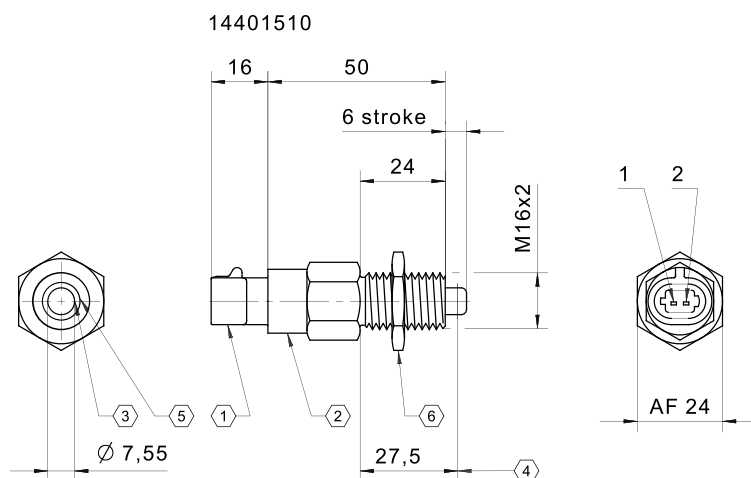
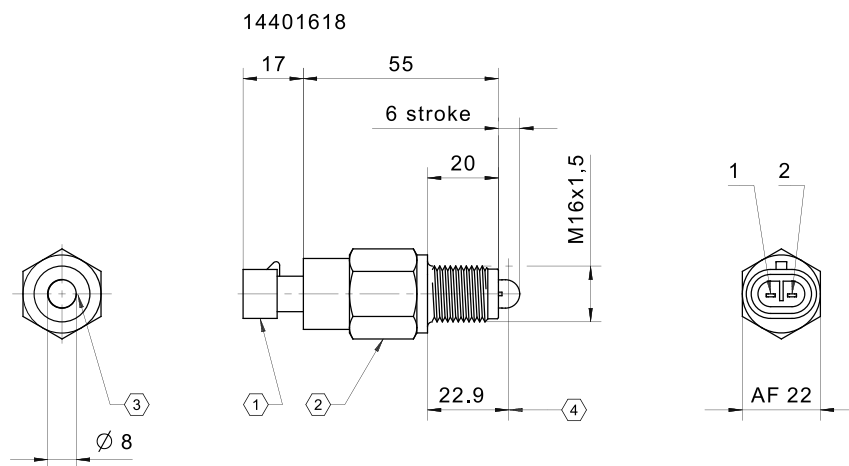
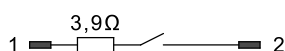

IMAGE 2/3



- ① connector - male Metri Pack - PA6
- ② housing - 1.0718 zinc-plated
- ③ pin - POM
- ④ switching point ON
- ⑤ wiper ring - TPE
- ⑥ nut - 1.0718 zinc-plated



- ① connector - male AMP Superseal 1.5 - PA6
- ② housing - 1.0718 zinc-plated
- ③ pin - POM
- ④ switching point ON

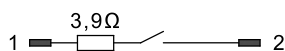
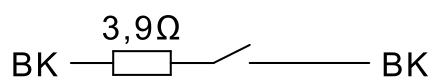
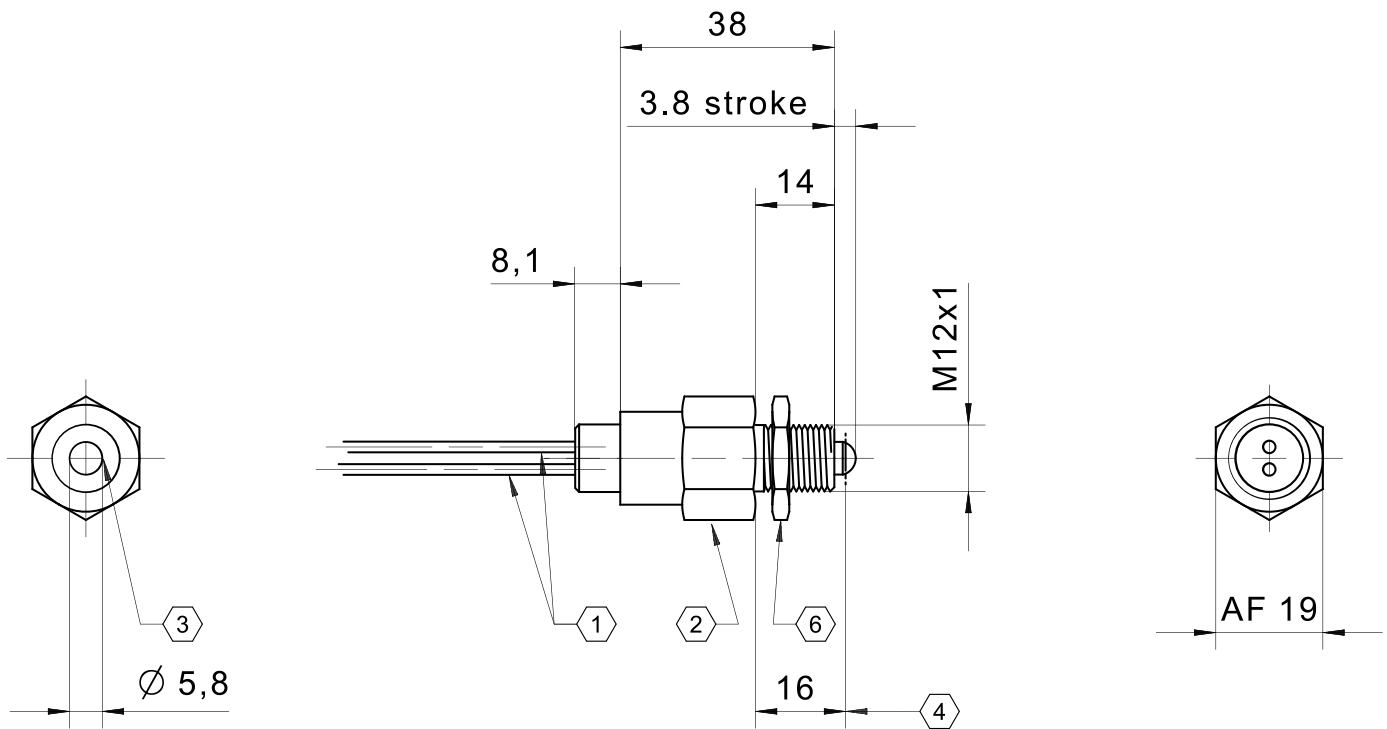

IMAGE 3/3

14452105



Article characteristics

Attribute	14400204	14401510	14452105	144810	144820	ED14400204 ▶
Max. switching voltage	48 V DC					-
Max. switching voltage	48 V AC					-
Max. switching current	0.3 A		0.5 A			-
Contact form	NO				NC	-
Technology	Reed					-
Max. switching power	0.34 W			10 W		-
Actuation	front					-
Switching principle	magnetic					-
Series resistor	3.9 Ohm			-		
Dimensions	L=56,25mm / SW22	L=66mm / SW19	L=50mm / SW19	L=95mm / SW24		-
Stroke	4.3 mm	6 mm	4 mm	12 mm		-
Housing material	1.0718 Fe/Zn10/B	1.0718 Fe/Zn8/Cn/T2		PA6GK30		-
Nut material	-	1.0718 Fe/Zn8/Cn/T2		PA6GK30		-
Cable material	-			PVC		-
Protection class	IP67 DIN EN 60529					-
Operating temperature min.	-25 °C	-30 °C	-25 °C			-
Max. operating temperature	130 °C	100 °C	85 °C	75 °C		-
Min. cable temperature range, moving	-			-5 °C		-
Max. cable temperature range, moving	-			70 °C		-
Min. cable temperature range, fixed installation	-			-25 °C		-
Max. cable temperature range, fixed installation	-			70 °C		-
Min. storage temperature	-25 °C	-30 °C	-25 °C			-
Max. storage temperature	130 °C	100 °C	85 °C	75 °C		-
Mounting type	Thread					-
Thread	9/16-18-2A UNF	M16x2	M12x1	M18x1		-
Connector type	AMP Superseal 2-pol.	Metri-Pack	-			
Cable length	-		0.5 m	1 m		-

Attribute	ED14401510	ED14452105	ED144810	ED144820
Max. switching voltage			-	
Max. switching voltage			-	
Max. switching current			-	
Contact form			-	
Technology			-	
Max. switching power			-	
Actuation			-	
Switching principle			-	
Series resistor			-	
Dimensions			-	
Stroke			-	
Housing material			-	
Nut material			-	
Cable material			-	
Protection class			-	
Operating temperature min.			-	
Max. operating temperature			-	
Min. cable temperature range, moving			-	
Max. cable temperature range, moving			-	
Min. cable temperature range, fixed installation			-	
Max. cable temperature range, fixed installation			-	
Min. storage temperature			-	
Max. storage temperature			-	
Mounting type			-	
Thread			-	
Connector type			-	
Cable length			-	