



## Magnetic sensor 128

### Product characteristics

- Magnetic sensor on reed-contact basis
- Small housing with external thread and fastening nuts for simple and space-saving installation
- M10 x 48 mm
- PVC cable
- Sturdy brass housing
- Variant with high switching voltage (up to 250 V) available

### Technical drawing

IMAGE 1/2

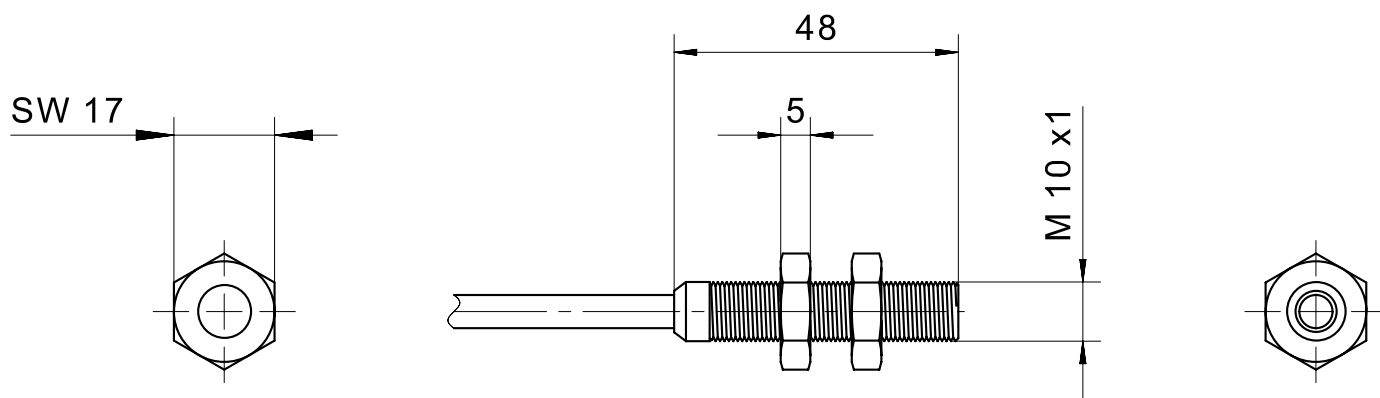
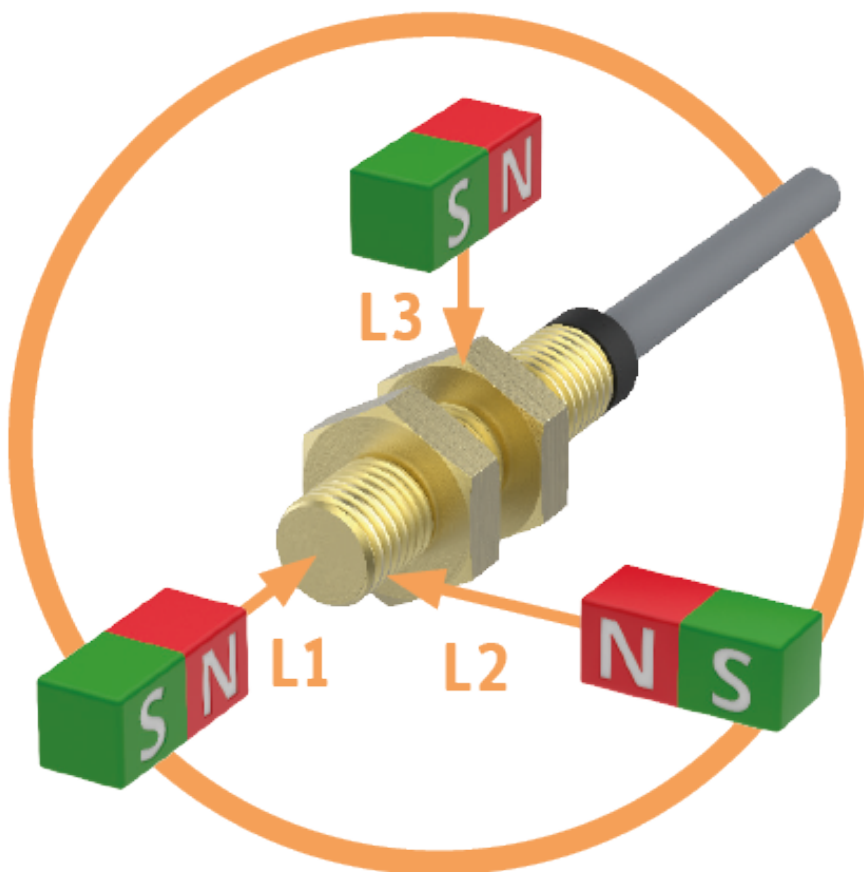

IMAGE 2/2

BN ————— BU

## Product options

IMAGE 1/2



## TYPICAL SWITCHING DISTANCES

|           | 128210 |       |       |
|-----------|--------|-------|-------|
| ACTUATORS | L1     | L2    | L3    |
| 324790    | 15 mm  | 13 mm | 9 mm  |
| 300790    | 19 mm  | 15 mm | 12 mm |
| 300780    | 26 mm  | 19 mm | 18 mm |

Further actuators and switching distances on request

IMAGE 2/2

## ORDERING KEY

|     |     |     |  |
|-----|-----|-----|--|
| 128 |     |     | Magnetic sensor, reed contact                            |
|     | 210 |     | N.O. – cable connection 1 m, switching voltage max. 48 V |
|     |     |     | Other contact forms on request                           |
|     |     |     |  |
|     |     |     | <b>Other available cable lengths</b>                     |
|     |     | -3  | 3 m  |
|     |     | -5  | 5 m  |
|     |     | -10 | 10 m   |
|     |     |     | Other cable materials and cable lengths on request       |

## Article characteristics

| Attribute  | 128210            |
|--|-------------------|
| Max. switching voltage                           | 48 V DC           |
| Max. switching voltage                           | 48 V AC           |
| Max. switching current                           | 0.5 A             |
| Max. switching power                             | 10 W              |
| Technology                                       | Reed              |
| Contact form                                     | NO                |
| LED display                                      | No                |
| Actuation  | arbitrary         |
| Switching principle                              | magnetic          |
| Dimensions                                       | M10x1 L=48        |
| Housing design                                   | cylindrical       |
| Housing material                                 | Messing           |
| Nut material                                     | Messing           |
| Cable material                                   | PVC               |
| Protection class                                 | IP67 DIN EN 60529 |
| Operating temperature min.                       | -25 °C            |
| Max. operating temperature                       | 75 °C             |
| Min. storage temperature                         | -25 °C            |
| Max. storage temperature                         | 75 °C             |
| Min. cable temperature range, moving             | -5 °C             |
| Max. cable temperature range, moving             | 70 °C             |
| Min. cable temperature range, fixed installation | -25 °C            |
| Max. cable temperature range, fixed installation | 70 °C             |
| Mounting type                                    | Thread            |
| Cable length                                     | 1 m               |