



## Magnetic sensor 122

### Product characteristics

- Magnetic sensor on reed-contact basis
- Small sensor design
- Simple mounting with external thread and fastening nuts
- PA housing
- M12 x 1 x 46 mm
- PVC cable

### Technical drawing

IMAGE 1/1

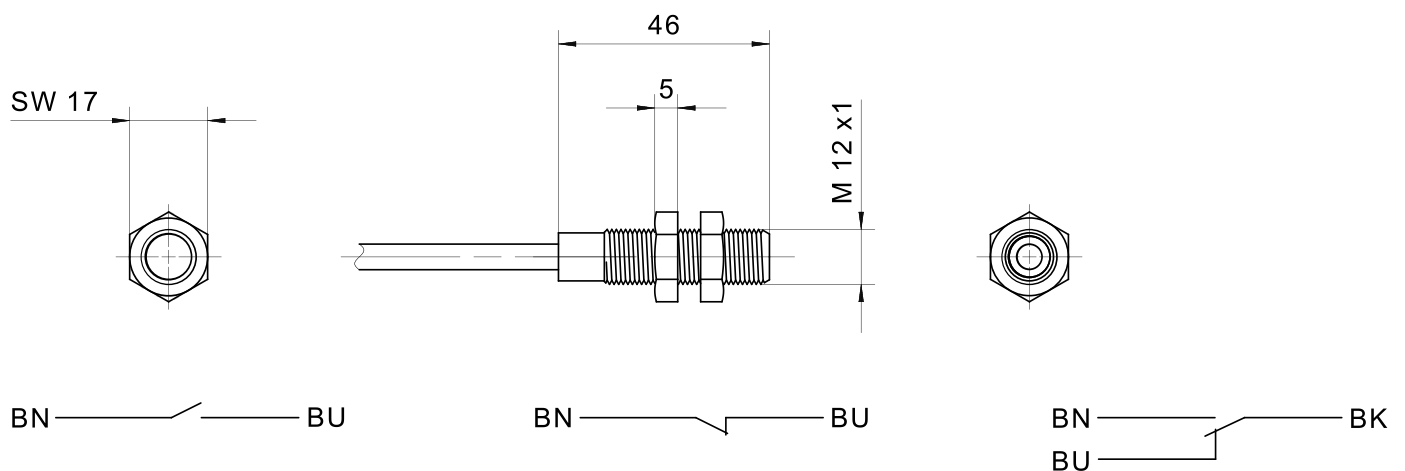

## Product options

IMAGE 1/2

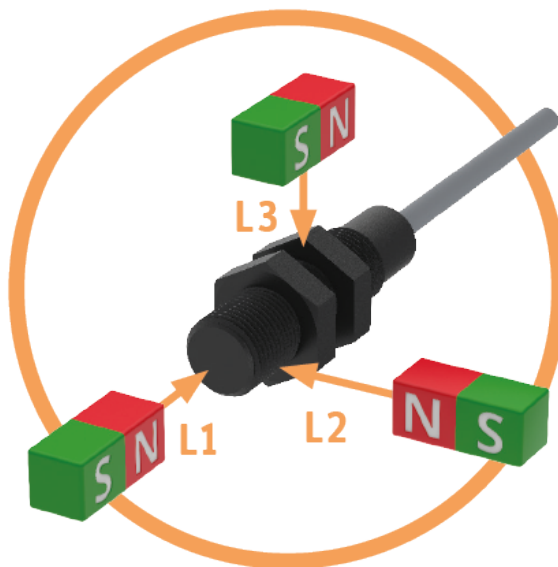

## TYPICAL SWITCHING DISTANCES

	122210			122210V			122220		
ACTUATORS	L1	L2	L3	L1	L2	L3	L1	L2	L3
324790	12	10	6	12	10	6	8	8	4
300790	15	14	10	15	14	10	11	12	7
300780	24	16	16	24	16	16	18	15	12

	122230		
ACTUATORS	L1	L2	L3
324790	17	15	10
300790	22	19	14
300780	32	25	23

Further actuators and switching  
distances on request

IMAGE 2/2

## ORDERING KEY

122			Magnetic sensor, reed contact
	210		N.O. – cable connection 1 m
	210V		N.O. – cable connection 1 m – stainless steel
	220		N.C. – cable connection 1 m
	230		C.O. – cable connection 1 m
			Other electrical data on request
			<b>Other available cable lengths</b>
		-3	3 m
		-5	5 m
		-10	10 m
			Other cable materials and cable lengths on request

## Article characteristics

Attribute	122230	122210	122210V	122220	ED122210	ED122210V 
Max. switching voltage	48 V DC				-	
Max. switching voltage	48 V AC				-	
Max. switching current	0.3 A	1 A			-	
Max. switching power	3 W	20 W			-	
Technology	Reed				-	
Contact form	CO	NO		NC	-	
LED display	No				-	
Actuation	arbitrary				-	
Switching principle	magnetic				-	
Dimensions	M12x1 L=46				-	
Housing design	cylindrical				-	
Mounting type	Thread				-	
Housing material	PA6		Edelstahl 1.4305	PA6	-	
Nut material	PA6		Edelstahl 1.4305	PA6	-	
Cable material	PVC				-	
Protection class	IP67 DIN EN 60529				-	
Operating temperature min.	-25 °C				-	
Max. operating temperature	75 °C				-	
Min. storage temperature	-25 °C				-	
Max. storage temperature	75 °C				-	
Min. cable temperature range, moving	-5 °C				-	
Max. cable temperature range, moving	70 °C				-	
Min. cable temperature range, fixed installation	-25 °C				-	
Max. cable temperature range, fixed installation	70 °C				-	
Cable length	1 m				-	

Attribute	ED122220	ED122230
Max. switching voltage	-	-
Max. switching voltage	-	-
Max. switching current	-	-
Max. switching power	-	-
Technology	-	-
Contact form	-	-
LED display	-	-
Actuation	-	-
Switching principle	-	-
Dimensions	-	-
Housing design	-	-
Mounting type	-	-
Housing material	-	-
Nut material	-	-
Cable material	-	-
Protection class	-	-
Operating temperature min.	-	-
Max. operating temperature	-	-
Min. storage temperature	-	-
Max. storage temperature	-	-
Min. cable temperature range, moving	-	-
Max. cable temperature range, moving	-	-
Min. cable temperature range, fixed installation	-	-
Max. cable temperature range, fixed installation	-	-
Cable length	-	-