



## Emergency stop button NHT04S

In addition to the illuminated anti-obstruction protective collar, emergency stop button NHT04S also has a key release. This ensures that only authorised persons can restart the machine after it has been stopped.

- Technical specifications
- Latching detent for anti-rotation protection and to prevent easy removal
- Optical switch position indicator (green ring)
- LED illumination available with the corresponding contact elements
- When used in combination with emergency stop enclosure NHG01, it can be used as a surface mounted version
- Matching installation wrench MS01 for simple installation
- Key release

### Suitable contact elements:

KE20 Contact element with 2 N.C. contacts

KE20SF Contact element with 2 N.C. contacts + failure protection\*

KE21 Contact element with 2 N.C. contacts + 1 N.O. contact

KE21SF Contact element with 2 N.C. contacts + 1 N.O. contact + failure protection\*

KE20SFB Contact element with 2 N.C. contacts + failure protection\* + illumination

KE21SFB Contact element with 2 N.C. contacts + 1 N.O. contact + failure protection\* + illumination

\*The failure protection system detects whether the contact elements are assembled correctly and switches the safety circuit off if a contact element should detach due to external influences.

### The following safety control units / safety relays are suited for integration into the safety product line:

470... eloFlex Mini 2 two-channel inputs, freely configurable

471... eloFlex 4 two-channel inputs, freely configurable

485 EP... eloProg up to 128 inputs, freely configurable

Technical drawing

IMAGE 1/1

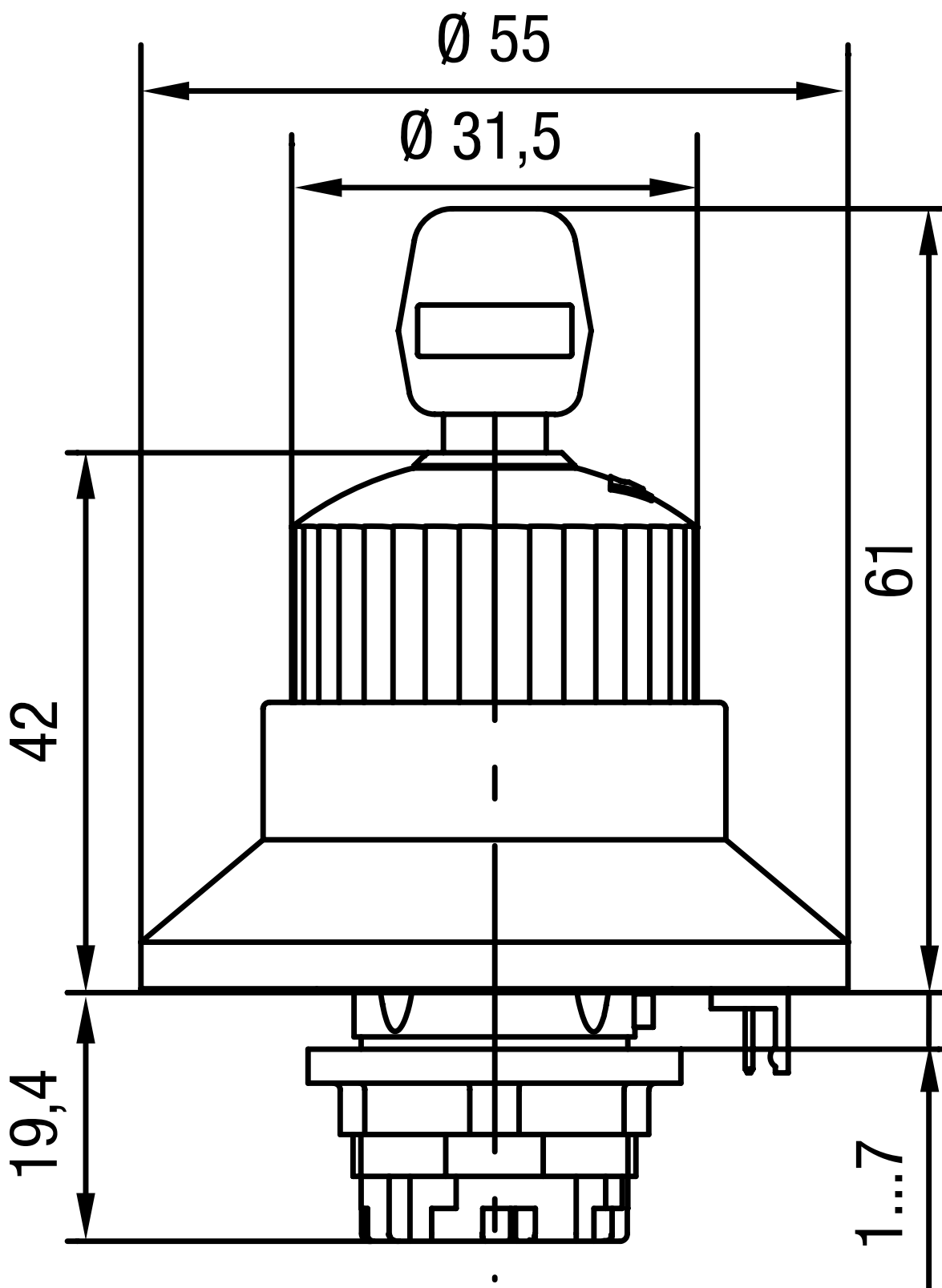

## Article characteristics

| Attribute                          | NHT04S   |
|------------------------------------|--|
| Illumination                       | Yes  |
| Unlocking device                   | Key release  |
| Anti-obstruction protective collar | yes  |
| Operation protective collar        | no   |
| Service life, mechanical (Cycles)  | 100000   |
| Dimensions                         | Ø55 x 80,4 mm  |
| Detent present                     | yes  |
| Housing material                   | Plastic  |
| Housing colour                     | Front bezel: yellow; Mushroom head: red                        |
| Protection class                   | IP54 DIN EN 60529  |
| Operating temperature min.         | -30 °C   |
| Max. operating temperature         | 55 °C  |
| Min. storage temperature           | -50 °C   |
| Max. storage temperature           | 85 °C  |
| Mounting type                      | Fastening nut  |
| Installation opening               | Ø22,3 mm Installation opening required for lighting connection |
| Installation                       | from above   |
| Torque for nuts                    | 2,2 N m  |
| Installation depth                 | 19.4 mm  |
| Certified in accordance with       | EN 60947-5-5 EN 60947-5-1 EN ISO 13850 UL 508 / CSA 22.2       |
| CE label                           | yes  |
| Hygienic approval                  | no   |