



Safety sensor 122MSV

The smallest type of cylindrical safety sensors from elobau – these sensors can hold their own despite their small size. The completely sealed stainless steel housing can withstand even intense cleaning with aggressive media at extreme temperatures (from -25 °C to +80 °C, IP6K9K protection class).

A reliable switching function is guaranteed by the large operating distance of up to 9.5 mm. In this age of miniaturization, it's the perfect solution for the hygienic environment of the food and packaging industry.

Technical specifications

- High offset values allow flexible installation
- Protection class IP6K9K, ideal for wash down applications
- Available connection types: M12 housing connector
- Matching actuator in M12 housing – 122MBV100

Technical drawing

IMAGE 1/3

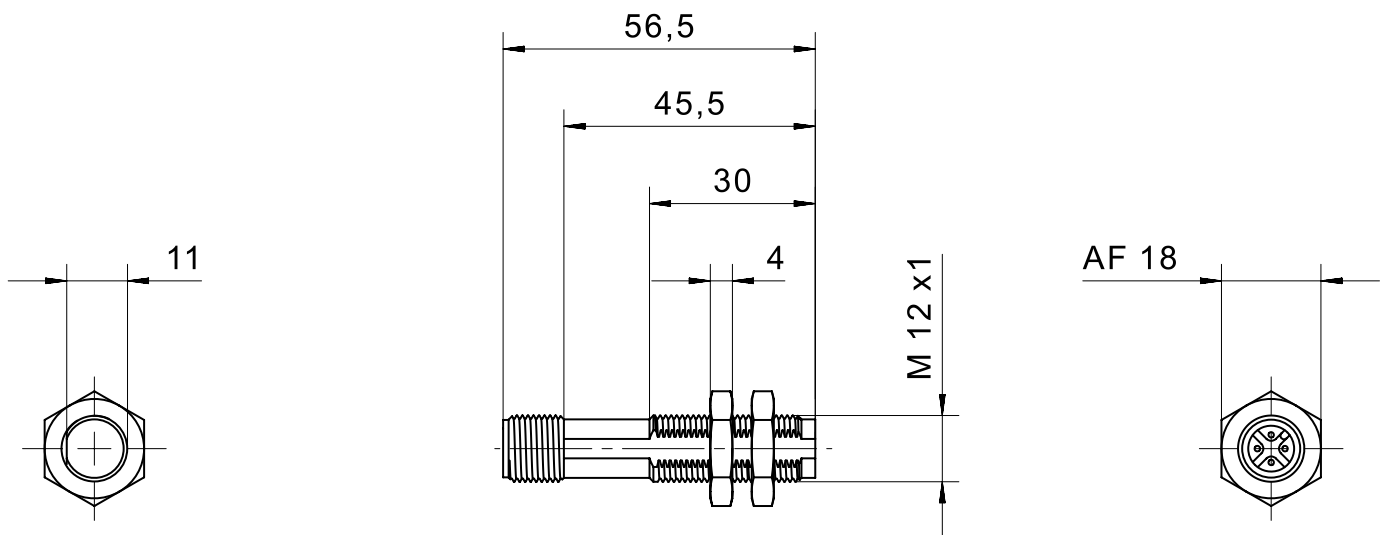

IMAGE 2/3

male M12

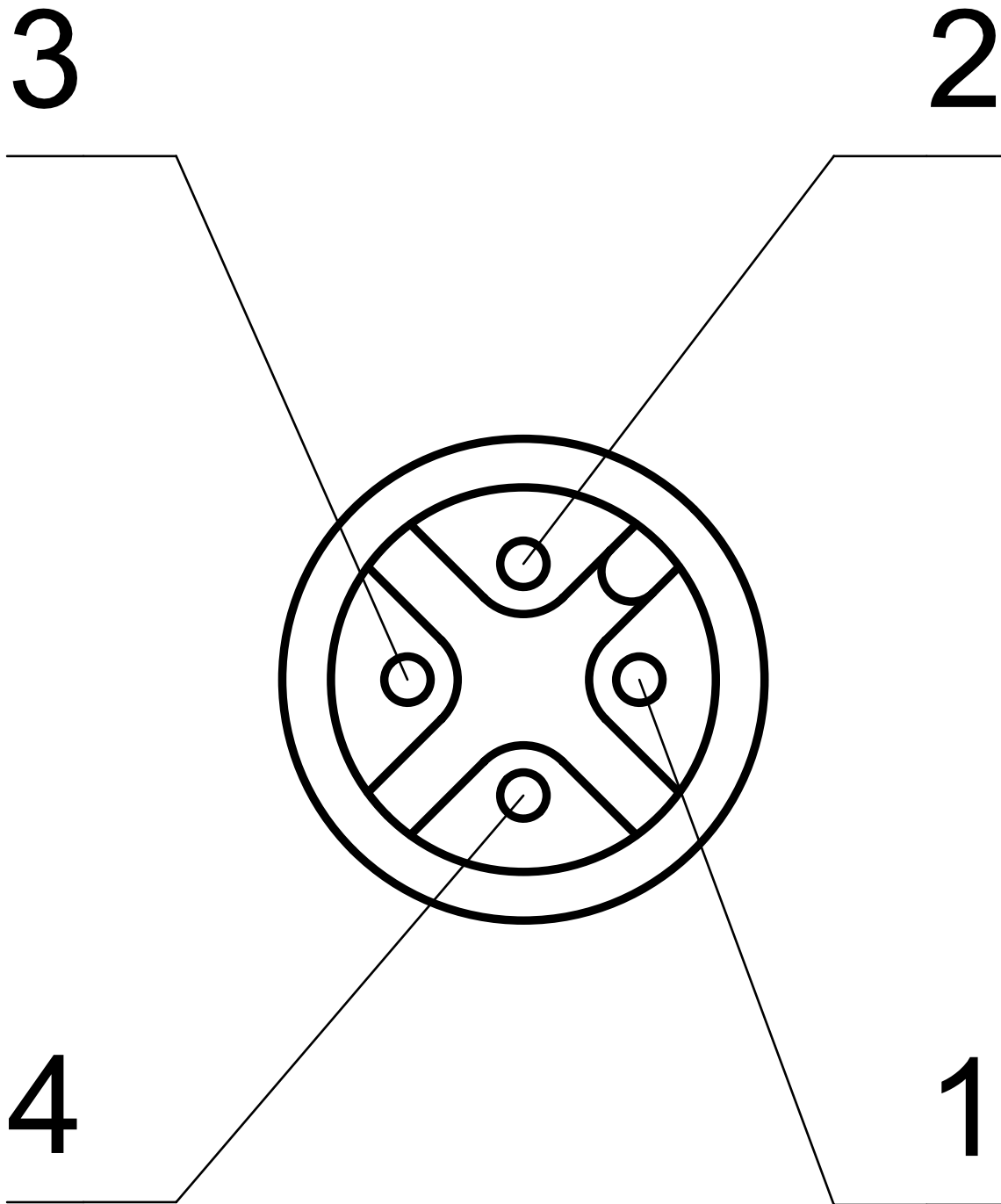
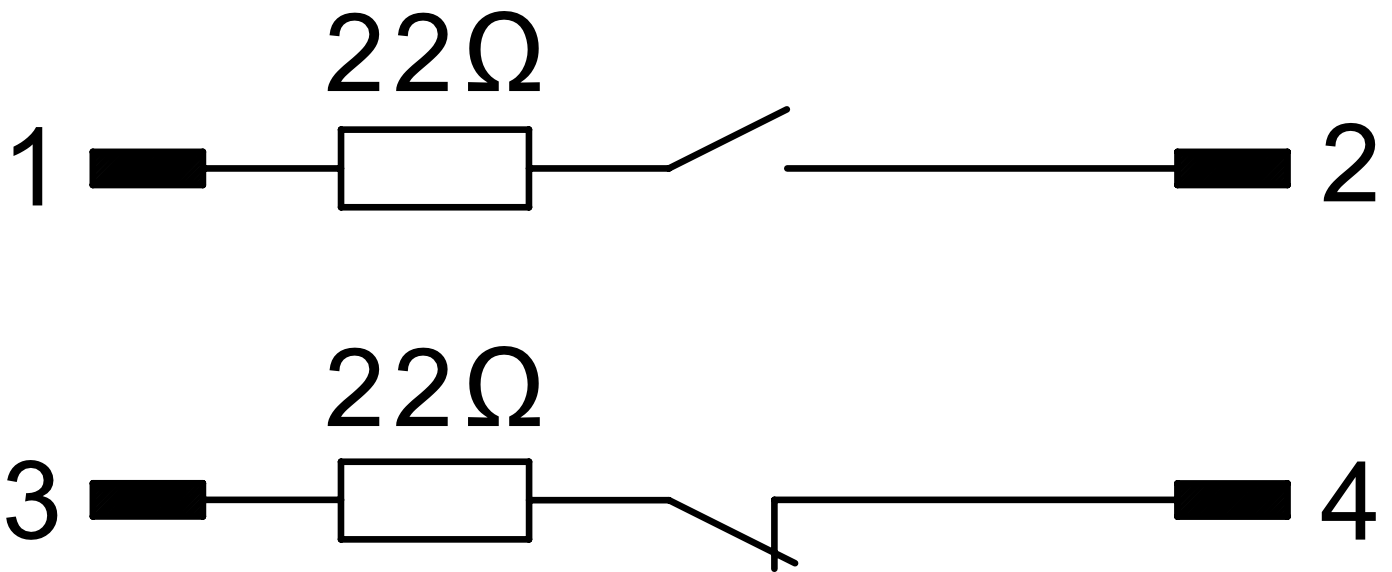

IMAGE 3/3

122MSV10G1G



Product options

IMAGE 1/2

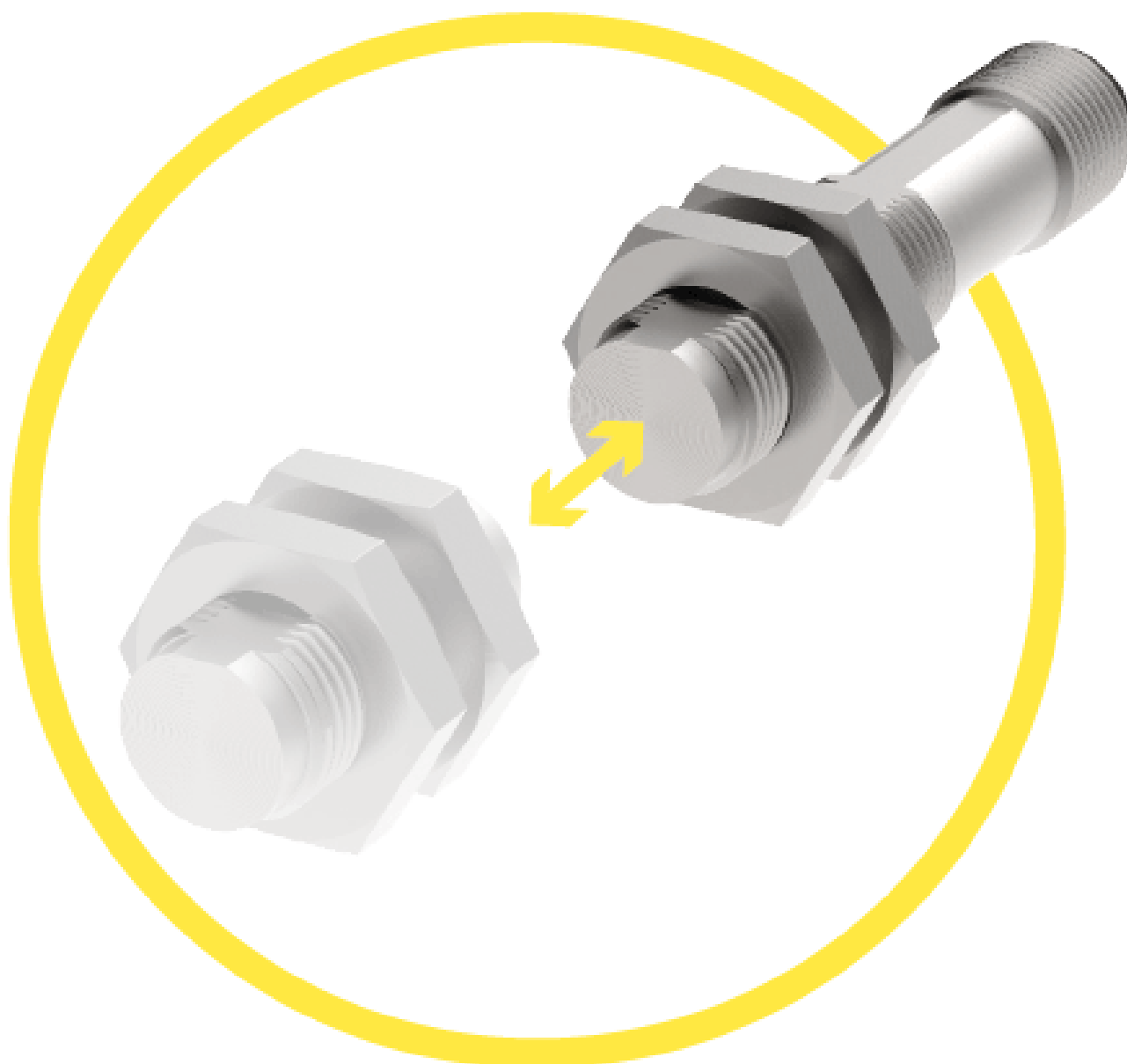

**Suitable for front actuation. Offset with magnet systems
122 MBV 100: max. 5 mm. Operating distance (Sao) from
5 to 9.5 mm. Assured switch-off distance (Sar) 25 mm**

IMAGE 2/2

ORDERING KEY

	122MSV10G1G
Stainless steel housing M12	x
M12x1 plug connection, 4-pin	x
N.O./N.C. contacts	x
Coded	x
Uncoded	-

MATCHING ACTUATORS

Actuators	Actuation direction	120V62V			
	Front	$S_{0_{min}}$	S_{ao}	S_{ar}	
122 MBV 100		0.5	9.5	25	

$S_{0_{min}}$ = minimum switching distance (mm), S_{ao} = operating distance (mm), S_{ar} = assured switch-off distance (mm)

Article characteristics

Attribute	122MSV10G1G	ED122MSV10G1G
Min. switching voltage	19.2 V DC	-
Max. switching voltage	28.8 V DC	-
Max. switching current	0.1 A	-
Max. switching power	3 W	-
Switching frequency	5 Hz	-
Assured switching distance (Sao)	9.5 mm	-
Assured switch-off distance (Sar)	25 mm	-
Minimum switching distance (S0 min)	0.5 mm	-
LED display	No	-
Actuation	front	-
Switching principle	magnetic	-
Series resistor	22 Ohm	-
Technology	Reed	-
Contact form	NO/NC	-
Pollution degree	3	-
Protection class	III	-
Coding acc. to EN ISO 14119	Low	-
B10d acc. to EN ISO 13849-1	20000000	-
Type acc. to EN ISO 14119	4	-
Mission time in years	20 a	-
Structure acc. to EN ISO 13849-1	Two-channel	-
Housing colour	silber	-
Housing design	cylindrical	-
Dimensions	M12 x 55,5 mm	-
Detent present	no	-
cannot be mounted flush	yes	-
Housing material	Edelstahl	-
Nut material	Edelstahl	-
Protection class	IP68 DIN EN 60529	-
Protection class, connector	IP68 DIN EN 60529	-
Operating temperature min.	-25 °C	-

Attribute	122MSV10G1G	ED122MSV10G1G
Max. operating temperature	80 °C	-
Shock resistance (Norm)	30g / 11ms	-
Vibration resistance (Norm)	10 - 55Hz	-
Min. storage temperature	-25 °C	-
Max. storage temperature	80 °C	-
Mounting type	Fastening nut	-
Thread	M12	-
Connector type	M12x1 - 4 polig	-
CE label	yes	-
Possible actuators	122MBV100	-