



Joystick Handle 341G/342G

Ergonomic actuation for right or left hand users.

The modular design of the ergonomic joystick handle allows it to be flexibly adapted to suit many applications. Can be individually equipped with up to 6 push buttons or 1 thumbwheel and 3 push button switches. That offers a wide range of additional operating functions.

Technical specifications

- The Joystick grip 341G has been ergonomically designed for right handed operators, and 342G for left handed operators
- Fully illuminated, night and function illumination options are also available
- The CAN controller integrated in the handle facilitates a simple bus connection (CANopen / SAE J1939)
- Handle available with micro push button switches for use outside of the cabin
- The corresponding mounting adapters are available for all standard joysticks
- Optionally available with capacitive presence detection
- Push button switches are available in various colours

Technical drawing

IMAGE 1/3

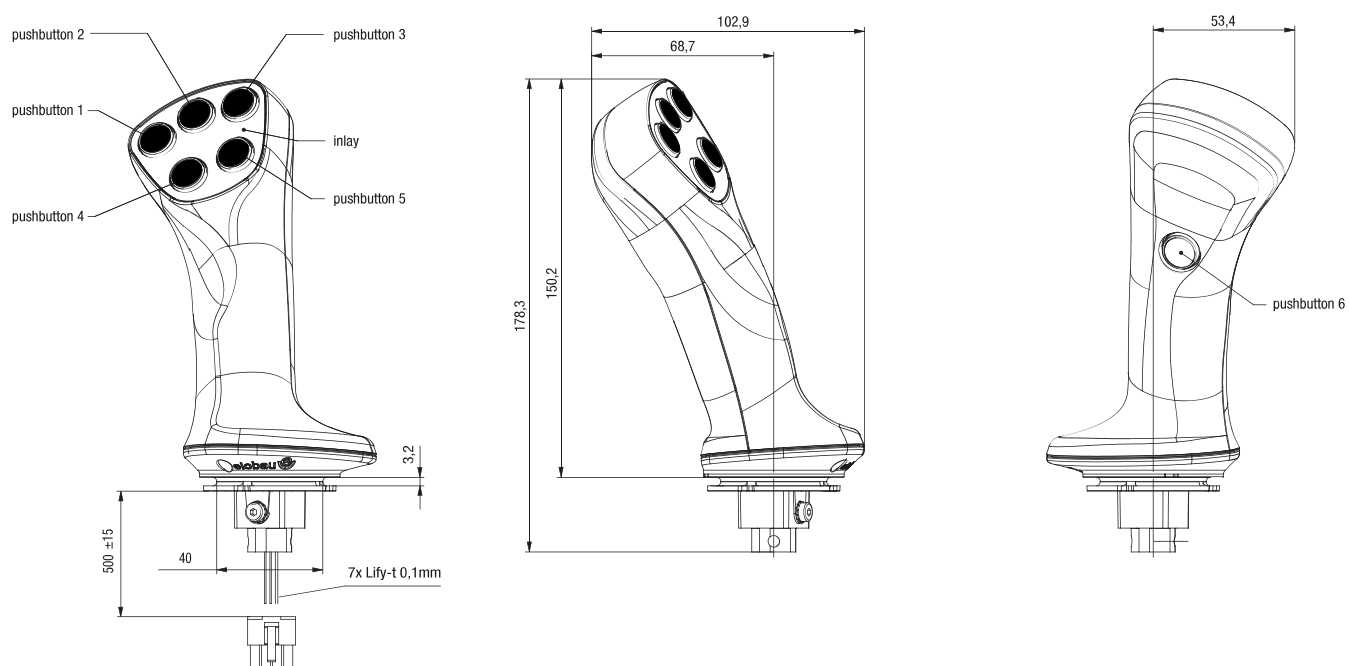
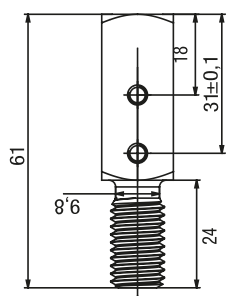

IMAGE 2/3

Installation adapter

Standard

Handle axis
External thread M12



Optional

Handle axis
Inner thread M12



Handle axis
External thread M14

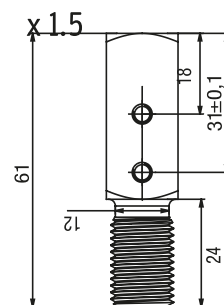
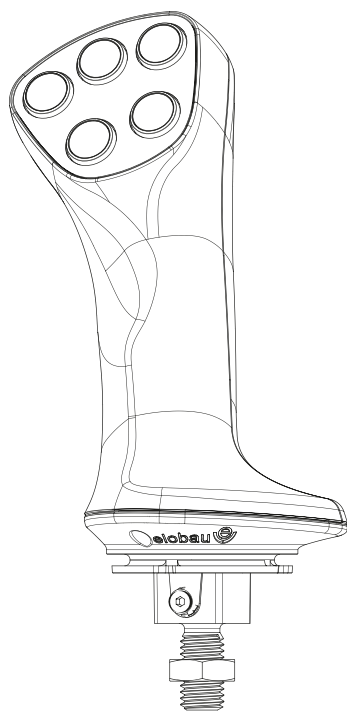
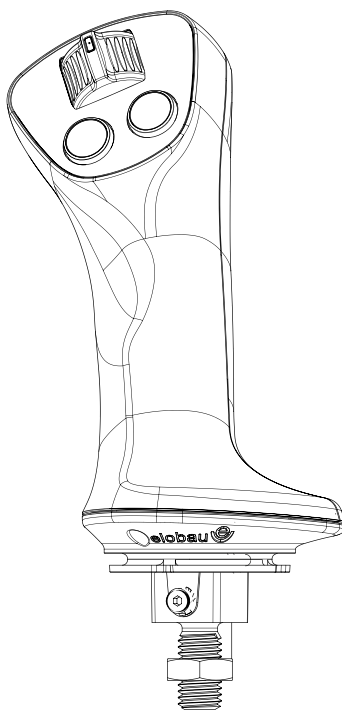

IMAGE 3/3



Type 1

Max. 6 push buttons with night and function illumination possible



Type 2

Max. 3 push buttons with night and function illumination possible.
Max. one thumbwheel with illumination

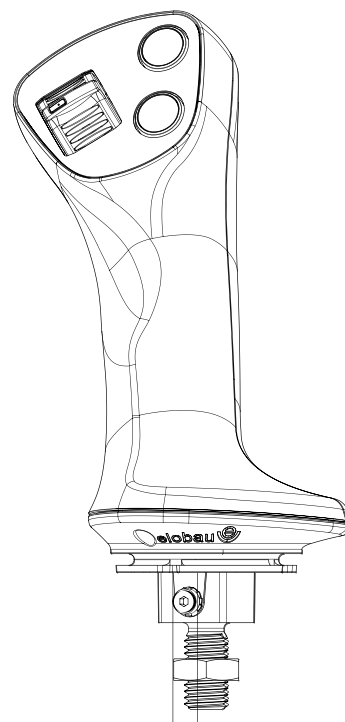

Type 3

Max. 3 push buttons with night and function illumination possible.
Max. one thumbwheel with illumination

Product options

IMAGE 1/1



Capacitive presence detection

The 341/342G is optionally available with a capacitive touch sensor to detect when operators are touching the handle.

Capacitive presence detection is not permissible for safety-critical applications!

Article characteristics

Attribute	34.G...
Operating temperature min.	-25 °C
Max. operating temperature	85 °C
Min. storage temperature	-40 °C
Max. storage temperature	85 °C
Shock resistance (Norm)	EN 60068-2-27
Cable length	0.5 m