



Circular connector M8 4-pin

Product characteristics

- High protection class as well as high temperature range to meet the demands of adverse industrial environments
- Circular connector for customised assembly

Technical drawing

IMAGE 1/6

351152

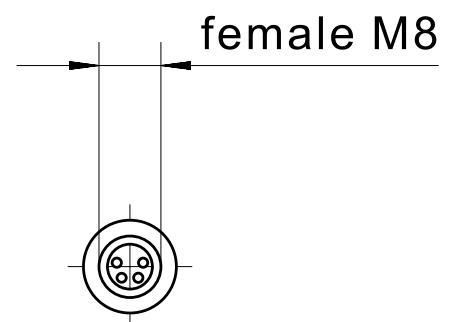
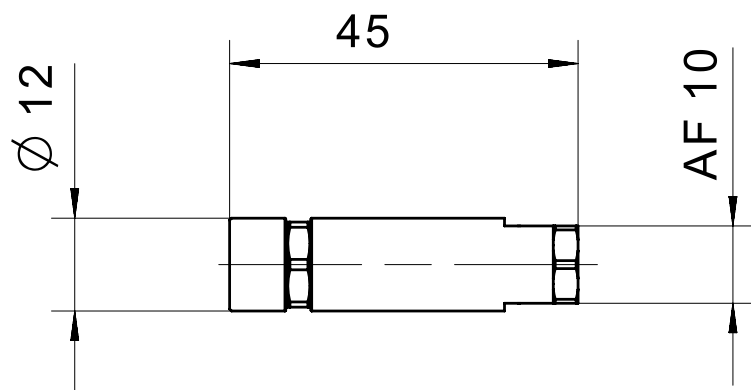

IMAGE 2/6

female M8

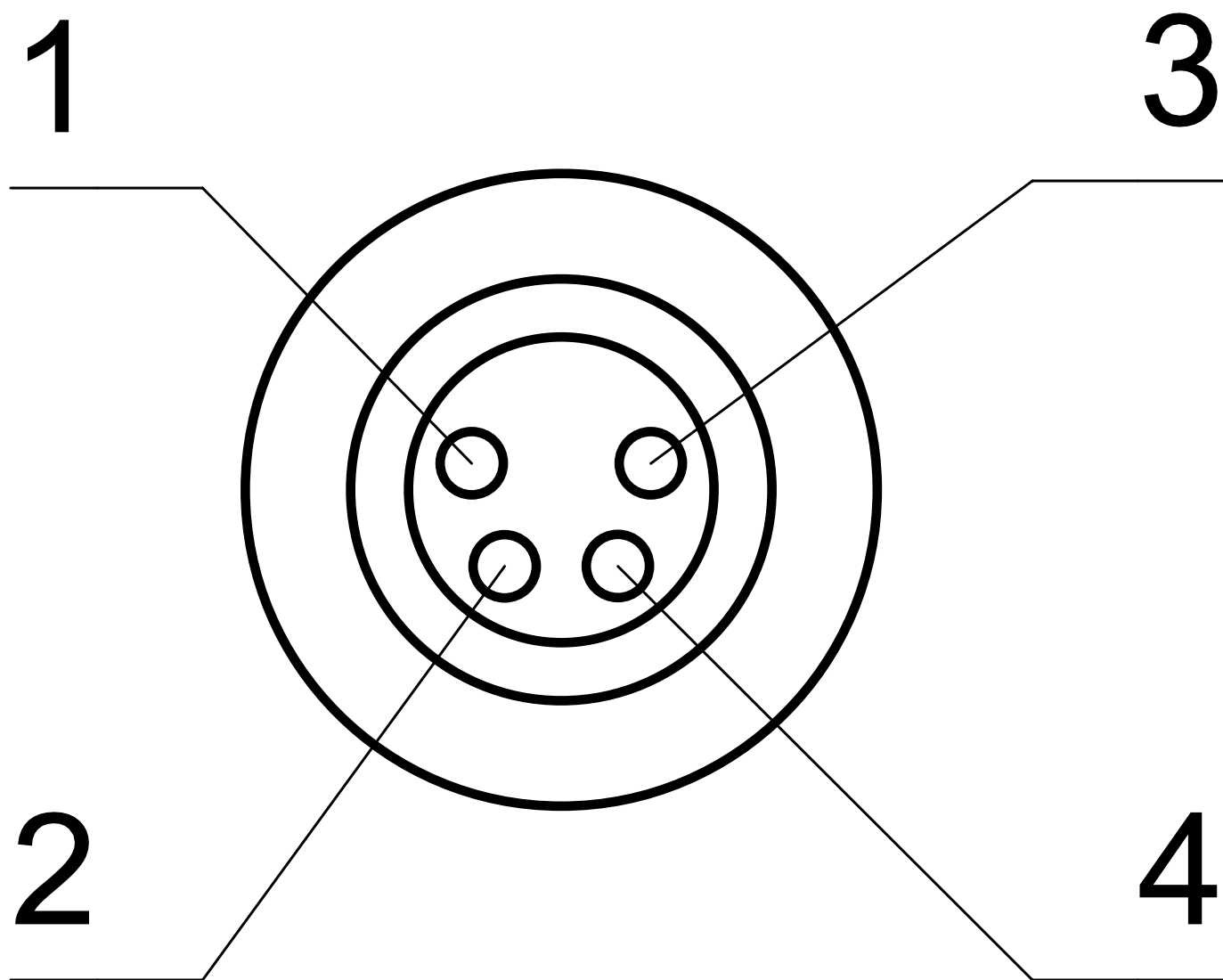

IMAGE 3/6

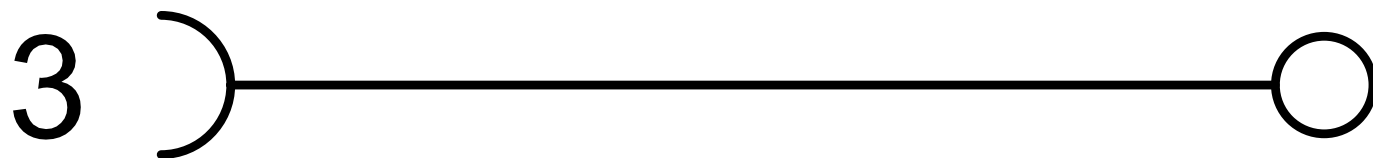
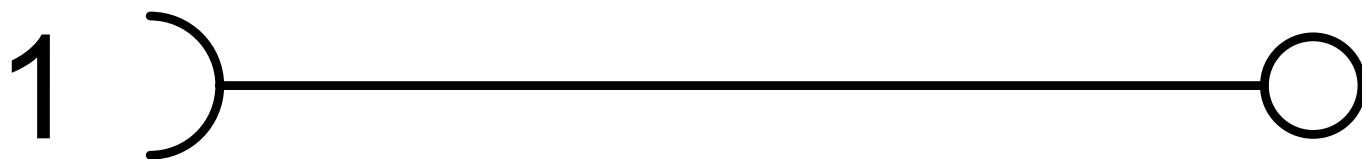

IMAGE 4/6

351153

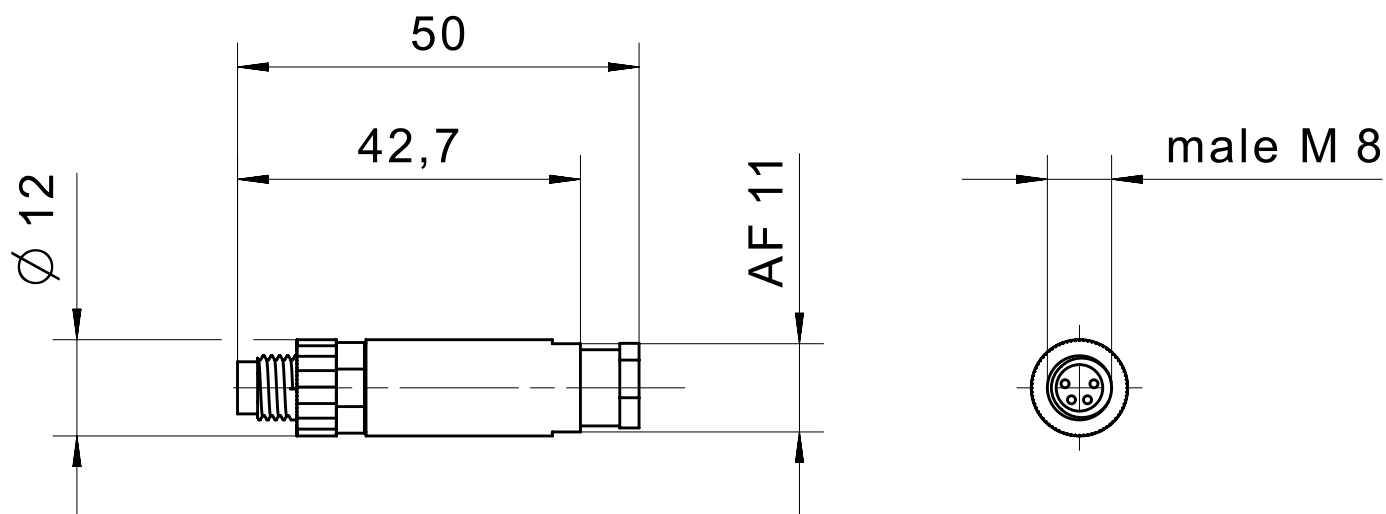

IMAGE 5/6

male M8

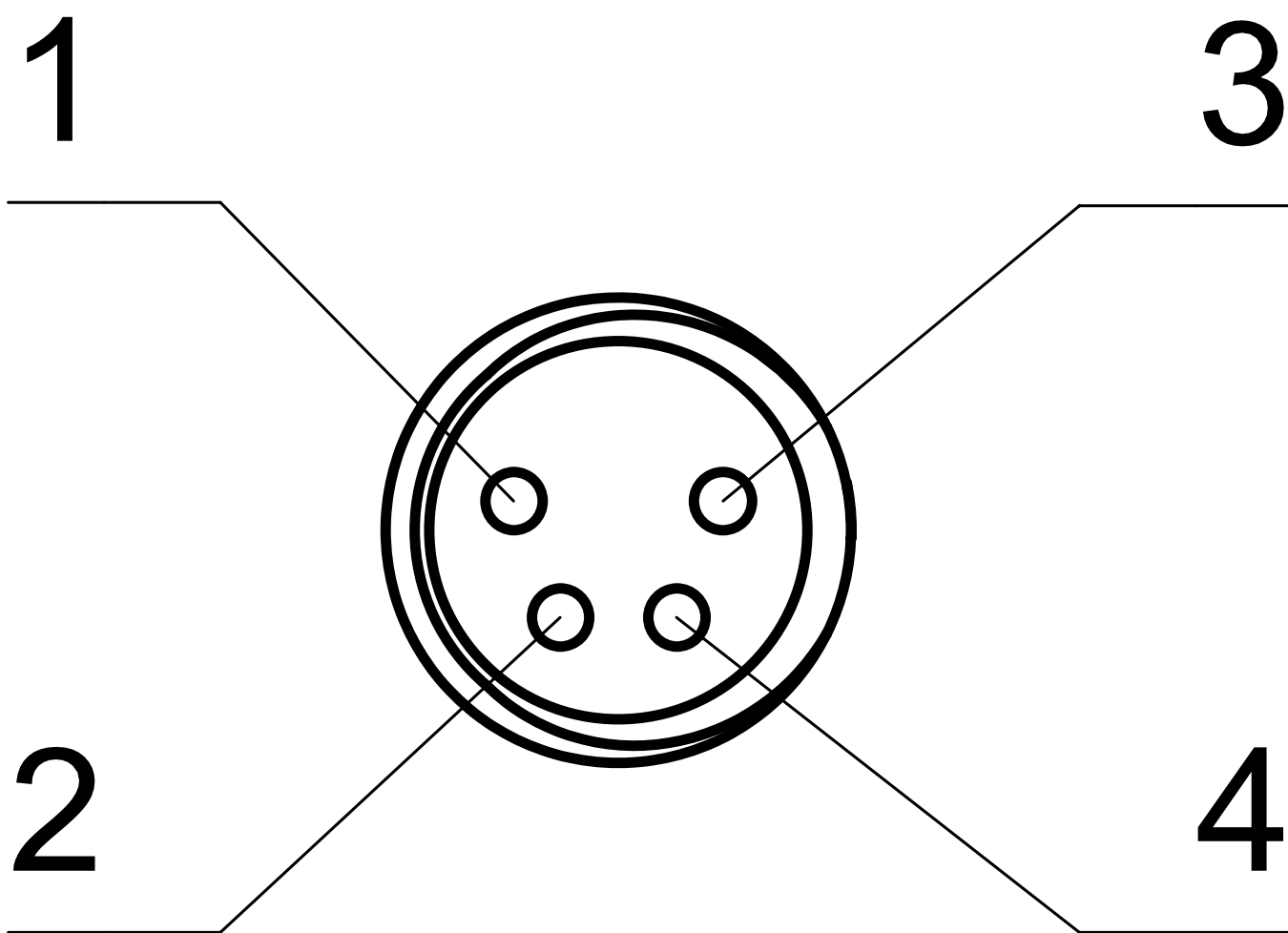
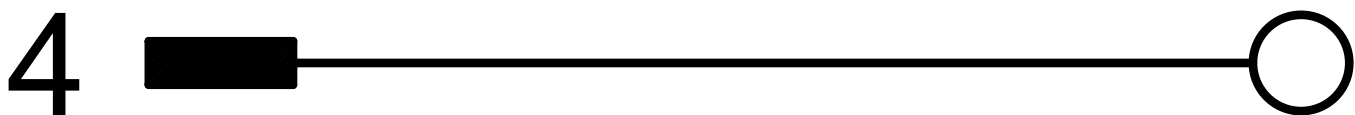
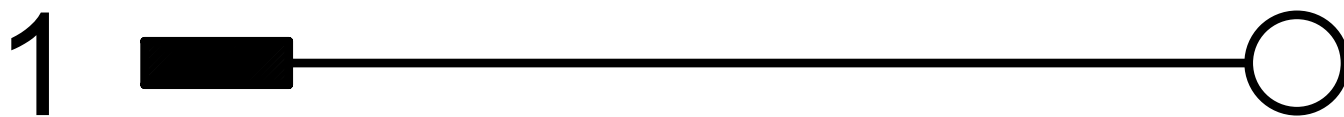

IMAGE 6/6



Product options

IMAGE 1/1

ORDERING KEY

351		Circular connector, 4-pin
	152	Coupling socket M8
	153	Coupling connector M8
	150	Coupling socket M12
	151	Coupling connector M12
		more coupling sockets / connectors on request

Article characteristics

Attribute	351152	351153	ED351152	ED351153
Pollution degree	3		-	
Max. switching current per contact	4 A		-	
Rated impulse withstand voltage (Uimp)	800 V		-	
Operating voltage max.	240 V DC		-	
Operating voltage max.	240 V AC		-	
Nut material	CuZi nickel-plated		-	
Overmould material	PA		-	
Operating temperature min.	-40 °C		-	
Max. operating temperature	85 °C		-	
Min. storage temperature	-40 °C		-	
Max. storage temperature	85 °C		-	
Torque for nuts	0,5 N m		-	
Connector type	M8 socket, straight	M8 connector, straight	-	
Cable diameter	3,5 - 5,5 mm		-	
Number of pins	4		-	
Connection type	Screw connection		-	
Min. connection cross section	0.14 mm²		-	
Max. connection cross section	0.5 mm²		-	