



## eloLance SL2R

### The eloLance – the new suction lance generation

The eloLance is the new generation of suction lances that gives you everything you need to make your systems and machines more efficient and reduce your workload.

The low extraction point enables economical, sustainable handling of liquids and reduces residual quantities in canisters and other containers. The high reliability and durability in different fluids, combined with simple, safe operation, are strong arguments for users. A quasi-analogue signal forms the basis for innovative IoT functions. These provide valuable application benefits such as detailed consumption analysis, predictive planning, automatic reordering, plausibility checks and container size detection.

### Product characteristics

- Seal-free design
- Low extraction point
- Easy handling due to ergonomic head
- Continuous level monitoring – Reed grid with 20 mm graduation
- High resistance due to optimised wall thickness for components in contact with media
- Clamping cone for variable height adjustment
- Horizontal hose and cable outlet
- Ball leakage brake

## Technical drawing

IMAGE 1/4

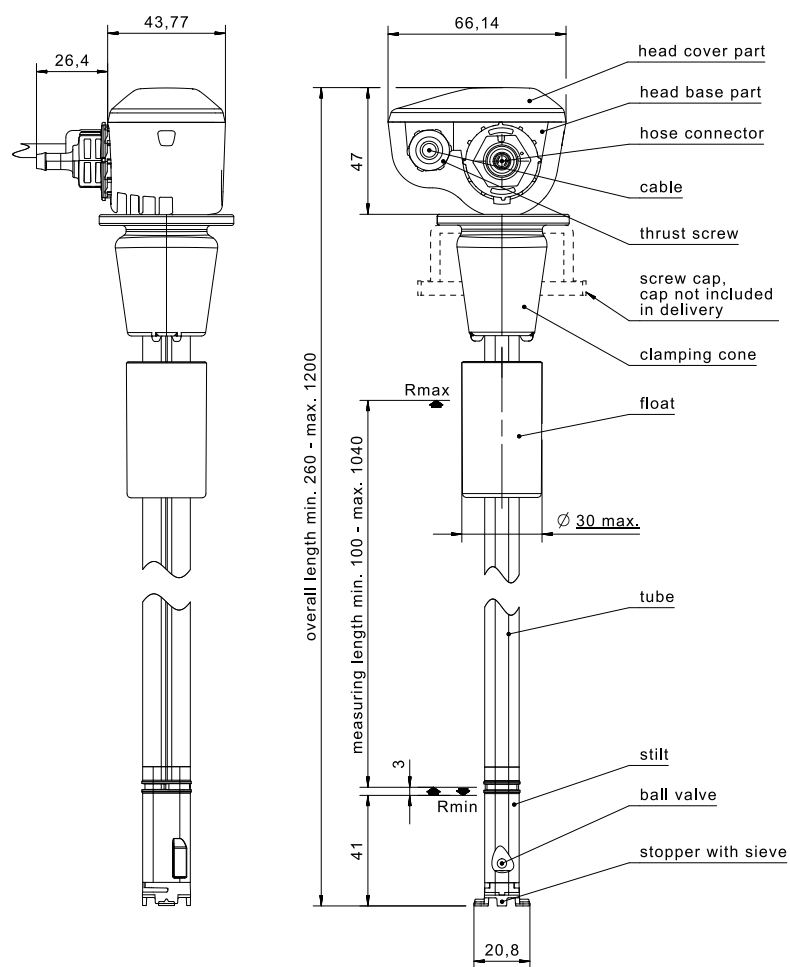
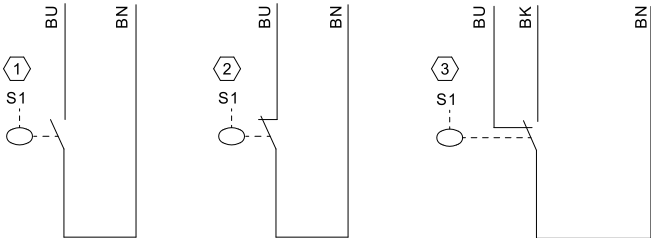

IMAGE 2/4





	S1 float cover at the top SF-A NO normally open switching function can be changed by turning the float
	S1 float cover below SF-B NC normally closed switching function can be changed by turning the float
	S1 float cover at the top SF-C changeover

IMAGE 3/4

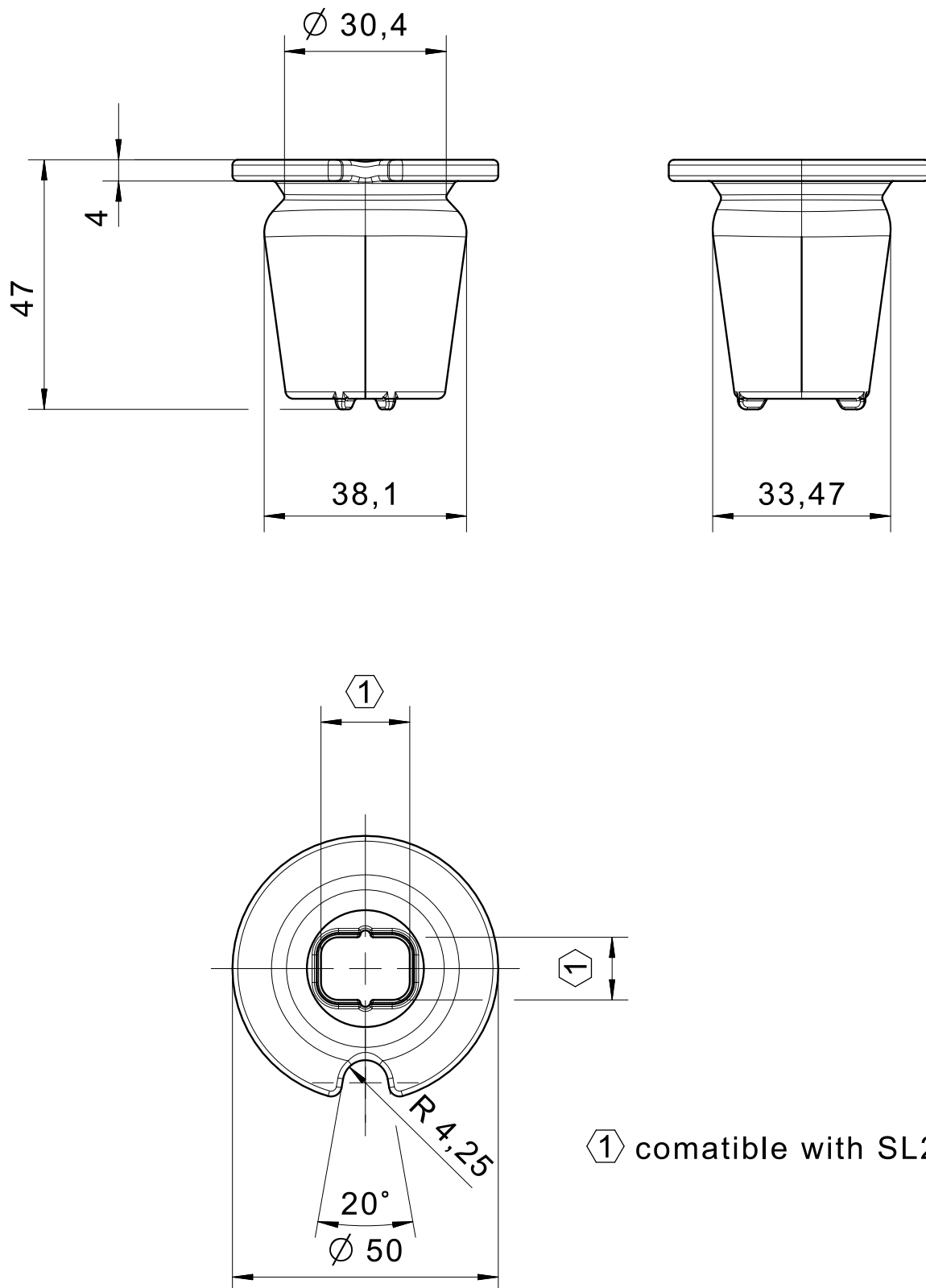
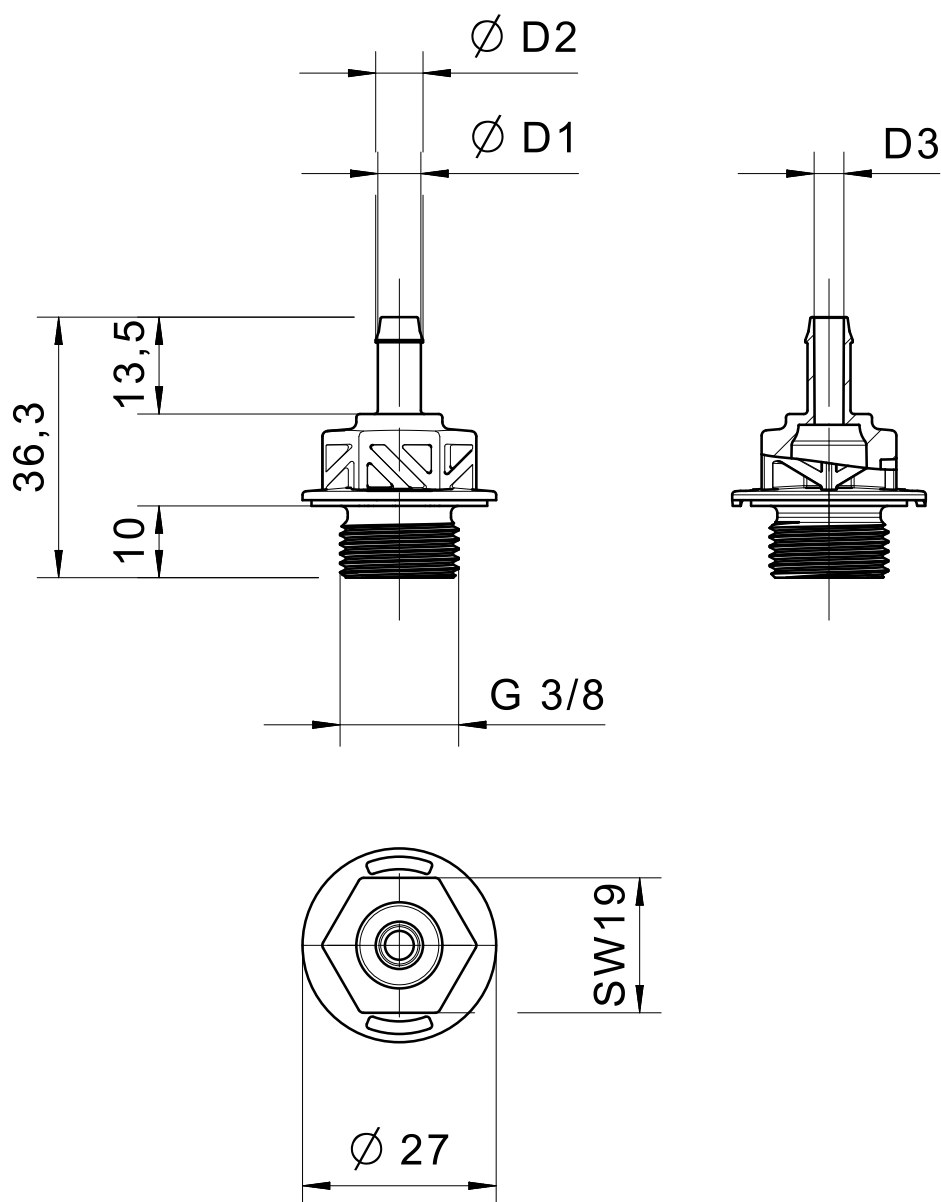

IMAGE 4/4



D1	D2	D3
Ø4	4,5	2
Ø6	6,6	4
Ø8	8,7	6

## Article characteristics

Attribute	SL2R3000005
Max. switching voltage	48 V AC
Max. switching voltage	48 V DC
Max. switching current	0.003 A
Max. switching power	10 VA
Output signal	digital
Technology	Reed
Max. resistance value	13800 Ohm
Min. resistance value	820 Ohm
Input voltage	48 V
Value single resistor	820 Ohm
Spacing	20 mm
Switching points	15 °
Switching point height Rmin	41 mm
Run-out brake	Gravity ball brake
Filter sieve	Filter mesh size 50 x 0,89mm <sup>2</sup>
Article marking	Laser marking
Structure	Seal free structure in immersed area
Overall length	440 mm
Immersion length max.	389 mm
Height/Width/Depth head piece	47mm x 66,14mm x 43,77mm
Float diameter	30 mm
Recommended minimum density of the medium	0.75 g/cm <sup>3</sup>
Housing material	PP/PVC/TPE
Float material	PE
Hose fitting material	PE
Riser material	PVC
Sealing ring material	-
Cable material	PVC
Hose material	-
Valve ball material	Glass
Container fastening material	Silicone
Protection class head piece	IP65 DIN EN 60529

#### Article characteristics

Attribute	SL2R3000005
Protection class below head piece	IPX8 DIN EN 60529
Operating temperature min.	5 °C
Max. operating temperature	60 °C
Min. storage temperature	-20 °C
Max. storage temperature	60 °C
Connection/outlets	Hose fitting for hose with inner diameter 6 mm
Installation opening	min. 30mm
Mounting type	Clamping cone
Connector type	-
Cable length	3 m
Connection type	End splice
Cable type	3x0,50mm² PVC LiYYöw/UL